



**Resources Department
Town Hall, Upper Street, London, N1 2UD**

AGENDA FOR THE LICENSING SUB COMMITTEE B

Members of Licensing Sub Committee B are summoned to a meeting, which will be held in Islington Town Hall, Upper Street, N1 2UD on, **1 August 2023 at 6.30 pm.**

Enquiries to : Emma Taylor
Tel : 020 7527 3486
E-mail : democracy@islington.gov.uk
Despatched : 24 July 2023

Membership

Councillor Bashir Ibrahim (Chair)
Councillor Nick Wayne (Vice-Chair)
Councillor Ilkay Cinko-Oner

Substitute

All other members of the Licensing committee

Quorum: is 3 Councillors

Welcome : Members of the public are welcome to attend this meeting.
Procedures to be followed at the meeting are attached.



A. Formal matters **Page**

1. Introductions and procedure
2. Apologies for absence
3. Declarations of substitute members
4. Declarations of interest

If you have a **Disclosable Pecuniary Interest*** in an item of business:

- if it is not yet on the council's register, you **must** declare both the existence and details of it at the start of the meeting or when it becomes apparent;
- you may **choose** to declare a Disclosable Pecuniary Interest that is already in the register in the interests of openness and transparency.

In both the above cases, you **must** leave the room without participating in discussion of the item.

If you have a **personal** interest in an item of business **and** you intend to speak or vote on the item you **must** declare both the existence and details of it at the start of the meeting or when it becomes apparent but you **may** participate in the discussion and vote on the item.

***(a) Employment, etc** - Any employment, office, trade, profession or vocation carried on for profit or gain.

(b) Sponsorship - Any payment or other financial benefit in respect of your expenses in carrying out duties as a member, or of your election; including from a trade union.

(c) Contracts - Any current contract for goods, services or works, between you or your partner (or a body in which one of you has a beneficial interest) and the council.

(d) Land - Any beneficial interest in land which is within the council's area.

(e) Licences - Any licence to occupy land in the council's area for a month or longer.

(f) Corporate tenancies - Any tenancy between the council and a body in which you or your partner have a beneficial interest.

(g) Securities - Any beneficial interest in securities of a body which has a place of business or land in the council's area, if the total nominal value of the securities exceeds £25,000 or one hundredth of the total issued share capital of that body or of any one class of its issued share capital.

This applies to **all** members present at the meeting.

5. Order of Business
6. Minutes of Previous Meeting

1 - 4

B. Items for Decision **Page**

1. HORNSEY ROAD SERVICE STATION, 213-217 HORNSEY ROAD, N7 6RA - variation 5 - 38
2. AMOR, 139 HOLLOWAY ROAD, LONDON, N7 8LX - new license application 39 - 76
3. KATSUMAMA, UNIT 4 ROSEBERY CT, 36A ROSEBERY AVENUE, EC1R 5HP - new license application 77 - 98

C. Urgent non-exempt items

Any non-exempt items which the Chair agrees should be considered urgently by reason of special circumstances. The reasons for urgency will be agreed by the Chair and recorded in the minutes.

D. Exclusion of public and press

To consider whether, in view of the nature of the remaining items on the agenda, any of them are likely to involve the disclosure of exempt or confidential information within the terms of the Access to Information Procedure Rules in the Constitution and, if so, whether to exclude the press and public during discussion thereof.

E. Urgent Exempt Items (if any)

Any exempt items which the Chair agrees should be considered urgently by reason of special circumstances. The reasons for urgency will be agreed by the Chair and recorded in the minutes.

ISLINGTON LICENSING SUB-COMMITTEES -

PROCEDURE FOR HEARING LICENSING APPLICATIONS UNDER THE LICENSING ACT 2003

INTRODUCTION

TIME GUIDE

- 1) The Chair of the Sub-Committee will open the meeting and invite all members of the Sub-Committee, Officers, the applicant and anybody making representations, including witnesses (who have been given permission to appear) to introduce themselves.
- 2) The Chair will introduce the application and draw attention to the procedure to be followed as detailed below.

CONSIDERATION OF APPLICATIONS:

N.B. The Sub-Committee have read all the papers. All parties should use this time to present a summary of their key points and not to repeat the detail already provided in the report.

- 3) **The Licensing Officer** will report any further information relating to the application or representations.
Where necessary the relevant parties will respond to these points during their submissions.
- 4) **Responsible Authorities** to present the key points of their representations; and clarify any points requested by the Authority. Witnesses, given permission by the Authority, may appear. 10 mins
- 5) The Sub-Committee to question the responsible authorities on matters arising from their submission.
- 6) **Interested Parties** to present the key points of their representations; and clarify any points requested by the Authority. Witnesses, given permission by the Authority, may appear. 10 mins
- 7) The Sub-Committee to question the objectors on matters arising from their submission.
- 8) **The applicant** to present the key points of their application, address the representations and clarify any points requested by the Authority. Witnesses given permission by the Authority may appear. 10 mins
- 9) The Sub-Committee to question the applicants on matters arising from their submission.
- 10) If required, the Licensing Officer to clarify matters relating to the application and the Licensing Policy.
- 11) The Chair may give permission for any party to question another party in the order of representations given above.

CASE SUMMARIES

- 12) **Responsible Authorities**
 - 13) **Interested parties**
 - 14) **Applicant**
- 2
mins
each

DELIBERATION AND DECISION

- 15) The Sub-Committee may retire to consider its decision. The Committee Clerk and Legal Officer will remain with the Sub-Committee.
- 16) If the Sub-Committee retires, all parties should remain available to provide further information or clarification.
- 17) The chair will announce their decision giving reasons and any conditions to be attached to the licence. All parties will be informed of the decision in writing.

London Borough of Islington

Licensing Sub Committee B - 16 May 2023

Minutes of the meeting of the Licensing Sub Committee B held at Committee Room 4, Town Hall, Upper Street, N1 2UD on 16 May 2023 at 6.30 pm.

Present: **Councillors:** Valerie Bossman-Quarshie, Phil Graham and Angelo Weekes (Chair)

Councillor Angelo Weekes in the Chair

64 **INTRODUCTIONS AND PROCEDURE (Item A1)**

Councillor Angelo Weekes welcomed everyone to the meeting and officers and members introduced themselves. The procedure for the conduct of the meeting was outlined.

65 **APOLOGIES FOR ABSENCE (Item A2)**

There were no apologies for absence.

66 **DECLARATIONS OF SUBSTITUTE MEMBERS (Item A3)**

There were no declarations of substitute members.

67 **DECLARATIONS OF INTEREST (Item A4)**

There were no declarations of interest.

68 **ORDER OF BUSINESS (Item A5)**

The order of business would be as the agenda.

69 **MINUTES OF PREVIOUS MEETING (Item A6)**

RESOLVED:

That the minutes of the meeting held on 19 March 2023 be confirmed as an accurate record of proceedings and the Chair be authorised to sign them.

70 **BUDGET SUPERMARKET, 18-20 CROUCH HILL, N4 4AU - PREMISES LICENCE VARIATION (Item B1)**

The licensing officer stated that there was no additional information to report.

The police reported that the applicant was seeking to vary condition 21. He was concerned that this condition had already been weakened and he considered that any further loosening of this condition would have a detrimental effect on the area. There were issues in the area such as street drinking and anti-social behaviour which made the area challenging.

In response to questions, it was noted that street drinking was commonplace in Elthorne Park. Holly Park estate also had hostels for vulnerable people and this area was one of the first areas to pilot Reducing the Strength drinking as it was

known as a hot spot. He had sought to clarify the price point and stated that the applicant had said that the alcohol would be bought at a unit cost to them of 75 pence.

The licensing agent stated that this was a small convenience store and a small change to a condition was requested to allow a greater number of products to be sold. It was proposed that alcohol would be sold at a price of 75 pence per unit. The number of units in a product would be multiplied by 0.75 in order to be able to be sold. Many shops did not have this condition.

In response to questions, the applicant's agent stated that the applicant wished to sell a wider range of products. Alcohol could then be sold but at a higher price point eg a 2.5l bottle of Frosty Jacks contained 18.8 units and could therefore not be sold for less than £14. The unit referred to in the condition was one unit of alcohol. The police had been consulted but did not agree with the condition, so the applicant had made a full application to go to the Sub-Committee. There had been no issues with this premises. The premises was already selling high strength alcohol and other shops in the area were selling high strength alcohol.

The Sub-Committee raised concerns regarding the 3am licence and it was stated that local supermarkets were only open until 1am. The licensing agent stated that if the shop sold whisky the Sub-Committee would not have these same concerns. He advised that shops in the local area already sold alcohol. Customers could buy alcohol locally in the Finsbury Park area and the licensing agent advised that they could condition to not serve this alcohol after midnight.

In summary, the police stated that even though the price point had been clarified this had not dissuaded them from their objection.

The licensing agent stated that the licensing objectives would be promoted by the minimum unit price and the high price of strong alcohol would dissuade street drinkers.

RESOLVED

That the application for a new premises licence, in respect of Budget Supermarket, 18-20 Crouch Hill, N4 4AU be refused.

REASONS FOR DECISION

The Sub-Committee listened to all the evidence and submissions and read all the material. The Sub-Committee reached the decision having given consideration to the Licensing Act 2003, as amended, and its regulations, the national guidance and the Council's Licensing Policy.

The application was for a variation of an existing premises licence. The existing licence permits off supplies sale of alcohol from Monday to Sunday from 7am to 3am the following day.

The Sub-Committee took into consideration the fact that the premises are situated in an area with a significant street drinking problem. Street drinkers and homeless people congregate in the area and there are street drinking shelters/homes in the area accommodating many vulnerable residents.

Licensing Sub Committee B - 16 May 2023

The premises are not situated in a specifically designated cumulative impact area but as an off sales business the premises fall under the ambit of Licensing Policy 4.

Under Licensing Policy 4, the Council has adopted a special policy relating to cumulative impact in relation to shops and other premises selling alcohol for consumption off the premises. The policy creates a rebuttable presumption that applications for the grant or variation of premises licences which are likely to add to the existing cumulative impact will normally be refused or subject to certain limitations, following the receipt of representations, unless the applicant can demonstrate in the operating schedule that there will be no negative cumulative impact on one or more of the licensing objectives.

The Sub-Committee noted the submissions of the Police representative who stated that in his opinion the adding of the additional condition would add to the risk of high strength alcohol being available for sale to vulnerable people in the area and by doing so would increase the prospects of crime and anti-social behaviour for the other residents.

The Sub Committee considered the fact that the applicant and/or his representative could not in their answers to specific questions from the Sub Committee, provide an explanation as to why the variation would benefit the business in any way. The applicant submitted that the variation as worded would provide stronger strength products at a far higher sale price than those of his competitors.

The existing conditions already provide for the sale of high strength beers, lagers and ciders provided they are sold in glass bottles. The reasoning behind this condition being to make the products unattractive to younger drinkers/front loaders and street drinkers. The proposed additional condition would be extremely difficult to enforce.

Licensing Policy 4 has been adopted specifically to control the ease of access to alcohol in street trading hotspots and in areas visited by vulnerable people.

There are possible exceptions to the cumulative impact policy for off sales of alcohol. Applicants need to demonstrate policies that restrict or prevent the sale of high strength beer, lager and cider, single cans and miniatures.

The Sub Committee was not satisfied that presumption in relation to Policy 4 had been rebutted in relation to the impact the granting of the variation would have.

Taking all factors into account the Sub Committee concluded that the proportionate and reasonable decision would be to refuse the application for the variation in order to promote the licensing objectives.

The meeting ended at 7.40 pm

CHAIR

This page is intentionally left blank

Regulatory Services/Licensing
222 Upper Street, London
N1 1XR

Report of: Director Community Safety, Resilience and Security

Meeting of: Licensing Sub-Committee B

Date: 01/08/2023

Ward(s): Tollington

Subject:

PREMISES LICENCE VARIATION APPLICATION

Re: HORNSEY ROAD SERVICE STATION, 213-217 HORNSEY ROAD, N7 6RA

1. Synopsis

- 1.1. This is an application for a variation of the premise licence under the Licensing Act 2003.
- 1.2. The premises currently holds a licence allowing:
 - **The sale of alcohol, Off the premises, Mondays to Sundays, from 08:00 to 23:00**
- 1.3. The variation application is to allow:
 - **The sale of alcohol, Off the premises, Mondays to Sundays, from 06:00 to 23:00.**
 - **To add the following conditions:**

- **There shall be no sale of single cans of beer, lager, or cider from the premises.**
- **There will be no sales/supplies of beer, lager, or cider with an ABV over 6% save for craft or premium beers.**

1.4. Relevant Representations:

Licensing Authority	Yes
Metropolitan Police	No
Noise	No
Health and Safety	No
Trading Standards	No
Public Health	No
Safeguarding Children	No
London Fire Brigade	No
Local residents	Yes: Three local residents
Other bodies	No:

2. Recommendations

- 2.1. To determine the application for a variation premises licence under Section 34 of the Licensing Act 2003;
- 2.2. If the Licensing Sub-Committee grants the application, it should be subject to:
- Conditions prepared by the Licensing Officer which are consistent with the Operating Schedule (see appendix 3); and
 - Any conditions deemed appropriate by the Licensing Sub-Committee to promote the four licensing objectives.

3. Background

- 3.1. This premises has held a licence since 2005 when it was converted from the Old Justices Licence to a Premises Licence under the Licensing Act 2003.

- 3.2. In September 2007, an application to transfer the licence and vary the Designated Premises Supervisor was made by Malthouse Retail Limited.
- 3.3. Designated Premises Supervisor variations were made in March and May 2010, December 2017, and May 2018. In May 2018, the DPS was varied to Parameswaran Jegan who remains the current DPS.
- 3.4. In April 2019, an application was made to transfer the licence from Malthurst Retail Limited to Motor Fuel Limited.
- 3.5. An application to vary the Licence was made in March 2020 to extend the sale of alcohol, update the plans attached to the licence, remove embedded conditions and to add a number of conditions.
- 3.6. This variation application was received by the Council's Licensing Service on 6th June 2023.
- 3.7. The Licensing Authority received representations from three local residents, copies of which can be found at Appendix 2.

4. Implications

4.1. Financial Implications

- 4.1.1. The Head of Finance reports that the applicant has paid the application fee of £190.00. Should the application be refused, the fee is not refundable.

4.2. Legal Implications

- 4.2.1. The legal implications are set out in Paragraph 2.
- 4.2.2. Legal advice will be provided at the meeting of the Licensing Sub-Committee, as necessary.

4.3. Environmental Implications and contribution to achieving a net zero carbon Islington by 2030

- 4.3.1. The Licensing Sub-Committee need to consider the impacts that that proposals will have on the environment. An impact is defined as any change to the environment, whether positive or negative, wholly, or partially resulting from Council activities. Almost all human activity has some impact on the environment, and it is very unlikely that any activity will not have any implications.

4.4. Equalities Impact Assessment

4.4.1. The council must, in the exercise of its functions, have due regard to the need to eliminate discrimination, harassment and victimisation, and to advance equality of opportunity, and foster good relations, between those who share a relevant protected characteristic and those who do not share it (section 149 Equality Act 2010). The council has a duty to have due regard to the need to remove or minimise disadvantages, take steps to meet needs, in particular steps to take account of disabled persons' disabilities, and encourage people to participate in public life. The council must have due regard to the need to tackle prejudice and promote understanding.

4.4.2. An Equalities Impact Assessment is not required in relation to this report, because this is a decision relating to a Premises Licence application under the Licensing Act 2003.

4.5. **Planning implications**

4.5.1. The Planning & Development Section have the following comments to make in relation to the above application.

4.5.2. The property is not statutorily listed and is not located within a Conservation Area.

4.5.3. Planning permission was granted on 21 September 1972 for the erection of a petrol filling station, together with a block of twelve maisonettes above and twelve private garages at the rear. (Ref:TP3675).

Condition (5) states: - The petrol filling station shall not open for use between the hours of midnight and 6am on any day.

4.5.4. There are no current enforcement cases relating to this site.

4.5.5. No planning objection.

5. **Conclusion and reasons for recommendations**

5.1. That the Licensing Sub-Committee determines this application.

Appendices:

Appendix 1: application form and current premises licence

Appendix 2: representations.

Appendix 3: suggested conditions and map of premises location.

Background papers:

- None.

Final report clearance:

Authorised by:

Janice Gibbons

Head of Regulatory Services

Date: 18/7/2023

Click or tap to enter a date.

Report author: Licensing Service

Tel: 020 75027 3031

E-mail: licensing@islington.gov.uk

* required information

Section 1 of 18

You can save the form at any time and resume it later. You do not need to be logged in when you resume.

System reference This is the unique reference for this application generated by the system.

Your reference You can put what you want here to help you track applications if you make lots of them. It is passed to the authority.

Are you an agent acting on behalf of the applicant?

Yes No

Put "no" if you are applying on your own behalf or on behalf of a business you own or work for.

Applicant Details

* First name

* Family name

* E-mail

Main telephone number Include country code.

Other telephone number

Indicate here if the applicant would prefer not to be contacted by telephone

Is the applicant:

Applying as a business or organisation, including as a sole trader
 Applying as an individual

A sole trader is a business owned by one person without any special legal structure. Applying as an individual means the applicant is applying so the applicant can be employed, or for some other personal reason, such as following a hobby.

Applicant Business

Is the applicant's business registered in the UK with Companies House? Yes No

Note: completing the Applicant Business section is optional in this form.

Registration number

Business name

If the applicant's business is registered, use its registered name.

VAT number

Put "none" if the applicant is not registered for VAT.

Legal status

Continued from previous page...

Applicant's position in the business

Home country

The country where the applicant's headquarters are.

Registered Address

Address registered with Companies House.

Building number or name

Street

District

City or town

County or administrative area

Postcode

Country

Agent Details

* First name

* Family name

* E-mail

Main telephone number

Include country code.

Other telephone number

Indicate here if you would prefer not to be contacted by telephone

Are you:

- An agent that is a business or organisation, including a sole trader
- A private individual acting as an agent

A sole trader is a business owned by one person without any special legal structure.

Agent Business

Is your business registered in the UK with Companies House? Yes No

Note: completing the Applicant Business section is optional in this form.

Registration number

Business name

If your business is registered, use its registered name.

VAT number

Put "none" if you are not registered for VAT.

Legal status

Continued from previous page...

Your position in the business

Home country

The country where the headquarters of your business is located.

Agent Registered Address

Address registered with Companies House.

Building number or name

Street

District

City or town

County or administrative area

Postcode

Country

Section 2 of 18

APPLICATION DETAILS

This application cannot be used to vary the licence so as to extend the period for which the licence has effect or to vary substantially the premises to which it relates. If you wish to make that type of change to the premises licence, you should make a new premises licence application under section 17 of the Licensing Act 2003.

I/we, as named in section 1, being the premises licence holder, apply to vary a premises licence under section 34 of the Licensing Act 2003 for the premises described in section 2 below.

* Premises Licence Number

Are you able to provide a postal address, OS map reference or description of the premises?

- Address OS map reference Description

Postal Address Of Premises

Building number or name

Street

District

City or town

County or administrative area

Postcode

Country

Premises Contact Details

Telephone number

Continued from previous page...

Non-domestic rateable value of premises (£)

14,750

Section 3 of 18

VARIATION

Do you want the proposed variation to have effect as soon as possible? Yes No

Do you want the proposed variation to have effect in relation to the introduction of the late night levy?

Yes No

You do not have to pay a fee if the only purpose of the variation for which you are applying is to avoid becoming liable to the late night levy.

If your proposed variation would mean that 5,000 or more people are expected to attend the premises at any one time, state the number expected to attend

Describe Briefly The Nature Of The Proposed Variation

Describe the premises. For example the type of premises, its general situation and layout and any other information which could be relevant to the licensing objectives. Where your application includes off-supplies of alcohol and you intend to provide a place for consumption of these off-supplies, you must include a description of where the place will be and its proximity to the premises.

The premises is a petrol forecourt store located at 213-217 Hornsey Road, London, N7 6RA.

The variation is to do the following:

1. To extend the hours for the sale of alcohol to between 0600 and 2300 daily.
2. To remove the restriction on hours for Good Friday & Christmas Day.
3. To include the additional conditions listed in section 16 of this application.

Section 4 of 18

PROVISION OF PLAYS

[See guidance on regulated entertainment](#)

Will the schedule to provide plays be subject to change if this application to vary is successful?

Yes No

Section 5 of 18

PROVISION OF FILMS

[See guidance on regulated entertainment](#)

Will the schedule to provide films be subject to change if this application to vary is successful?

Yes No

Continued from previous page...

Section 6 of 18

PROVISION OF INDOOR SPORTING EVENTS

[See guidance on regulated entertainment](#)

Will the schedule to provide indoor sporting events be subject to change if this application to vary is successful?

- Yes No

Section 7 of 18

PROVISION OF BOXING OR WRESTLING ENTERTAINMENTS

[See guidance on regulated entertainment](#)

Will the schedule to provide boxing or wrestling entertainments be subject to change if this application to vary is successful?

- Yes No

Section 8 of 18

PROVISION OF LIVE MUSIC

[See guidance on regulated entertainment](#)

Will the schedule to provide live music be subject to change if this application to vary is successful?

- Yes No

Section 9 of 18

PROVISION OF RECORDED MUSIC

[See guidance on regulated entertainment](#)

Will the schedule to provide recorded music be subject to change if this application to vary is successful?

- Yes No

Section 10 of 18

PROVISION OF PERFORMANCES OF DANCE

[See guidance on regulated entertainment](#)

Will the schedule to provide performances of dance be subject to change if this application to vary is successful?

- Yes No

Section 11 of 18

PROVISION OF ANYTHING OF A SIMILAR DESCRIPTION TO LIVE MUSIC, RECORDED MUSIC OR PERFORMANCES OF DANCE

[See guidance on regulated entertainment](#)

Will the schedule to provide anything similar to live music, recorded music or performances of dance be subject to change if this application to vary is successful?

- Yes No

Continued from previous page...

Section 12 of 18

PROVISION OF LATE NIGHT REFRESHMENT

Will the schedule to provide late night refreshment be subject to change if this application to vary is successful?

- Yes No

Section 13 of 18

SUPPLY OF ALCOHOL

Will the schedule to supply alcohol be subject to change if this application to vary is successful?

- Yes No

Standard Days And Timings

MONDAY

Start

End

Start

End

Provide timings in 24 hour clock (e.g., 16:00) and only give details for the days of the week when you intend the premises to be used for the activity.

TUESDAY

Start

End

Start

End

WEDNESDAY

Start

End

Start

End

THURSDAY

Start

End

Start

End

FRIDAY

Start

End

Start

End

SATURDAY

Start

End

Start

End

SUNDAY

Start

End

Start

End

Continued from previous page...

Will the sale of alcohol be for consumption?

- On the premises Off the premises Both

If the sale of alcohol is for consumption on the premises select on, if the sale of alcohol is for consumption away from the premises select off. If the sale of alcohol is for consumption on the premises and away from the premises select both.

State any seasonal variations.

For example (but not exclusively) where the activity will occur on additional days during the summer months.

Non-standard timings. Where the premises will be used for the supply of alcohol at different times from those listed above, list below.

For example (but not exclusively), where you wish the activity to go on longer on a particular day e.g. Christmas Eve.

Section 14 of 18

ADULT ENTERTAINMENT

Highlight any adult entertainment or services, activities, or other entertainment or matters ancillary to the use of the premises that may give rise to concern in respect of children.

Provide information about anything intended to occur at the premises or ancillary to the use of the premises which may give rise to concern in respect of children, regardless of whether you intend children to have access to the premises, for example (but not exclusively) nudity or semi-nudity, films for restricted age groups etc gambling machines etc.

NA

Section 15 of 18

HOURS PREMISES ARE OPEN TO THE PUBLIC

Standard Days And Timings

MONDAY

Start

End

Start

End

Provide timings in 24 hour clock (e.g., 16:00) and only give details for the days of the week when you intend the premises to be used for the activity.

TUESDAY

Start

End

Start

End

Continued from previous page...

WEDNESDAY

Start End

Start End

THURSDAY

Start End

Start End

FRIDAY

Start End

Start End

SATURDAY

Start End

Start End

SUNDAY

Start End

Start End

State any seasonal variations.

For example (but not exclusively) where the activity will occur on additional days during the summer months.

Non standard timings. Where you intend to use the premises to be open to the members and guests at different times from those listed above, list below.

For example (but not exclusively), where you wish the activity to go on longer on a particular day e.g. Christmas Eve.

Identify those conditions currently imposed on the licence which you believe could be removed as a consequence of the proposed variation you are seeking.

None, the existing conditions will remain on the licence.

I have enclosed the premises licence

Continued from previous page...

I have enclosed the relevant part of the premises licence

Reasons why I have failed to enclose the premises licence or relevant part of premises licence.

Section 16 of 18

LICENSING OBJECTIVES

Describe the steps you intend to take to promote the four licensing objectives:

a) General – all four licensing objectives (b,c,d,e)

List here steps you will take to promote all four licensing objectives together.

b) The prevention of crime and disorder

1. There shall be no sale of single cans of beer, lager, or cider from the premises.
2. There will be no sales/supplies of beer, lager or cider with an ABV over 6% save for craft or premium beers.

c) Public safety

d) The prevention of public nuisance

e) The protection of children from harm

Section 17 of 18

NOTES ON REGULATED ENTERTAINMENT

Continued from previous page...

In terms of specific **regulated entertainments** please note that:

- Plays: no licence is required for performances between 08:00 and 23.00 on any day, provided that the audience does not exceed 500.
- Films: no licence is required for 'not-for-profit' film exhibition held in community premises between 08.00 and 23.00 on any day provided that the audience does not exceed 500 and the organiser (a) gets consent to the screening from a person who is responsible for the premises; and (b) ensures that each such screening abides by age classification ratings.
- Indoor sporting events: no licence is required for performances between 08.00 and 23.00 on any day, provided that the audience does not exceed 1000.
- Boxing or Wrestling Entertainment: no licence is required for a contest, exhibition or display of Greco-Roman wrestling, or freestyle wrestling between 08.00 and 23.00 on any day, provided that the audience does not exceed 1000. Combined fighting sports – defined as a contest, exhibition or display which combines boxing or wrestling with one or more martial arts – are licensable as a boxing or wrestling entertainment rather than an indoor sporting event.
- Live music: no licence permission is required for:
 - o a performance of unamplified live music between 08.00 and 23.00 on any day, on any premises.
 - o a performance of amplified live music between 08.00 and 23.00 on any day on premises authorised to sell alcohol for consumption on those premises, provided that the audience does not exceed 500.
 - o a performance of amplified live music between 08.00 and 23.00 on any day, in a workplace that is not licensed to sell alcohol on those premises, provided that the audience does not exceed 500.
 - o a performance of amplified live music between 08.00 and 23.00 on any day, in a church hall, village hall, community hall, or other similar community premises, that is not licensed by a premises licence to sell alcohol, provided that (a) the audience does not exceed 500, and (b) the organiser gets consent for the performance from a person who is responsible for the premises.
 - o a performance of amplified live music between 08.00 and 23.00 on any day, at the non-residential premises of (i) a local authority, or (ii) a school, or (iii) a hospital, provided that (a) the audience does not exceed 500, and (b) the organiser gets consent for the performance on the relevant premises from: (i) the local authority concerned, or (ii) the school or (iii) the health care provider for the hospital.
- Recorded Music: no licence permission is required for:
 - o any playing of recorded music between 08.00 and 23.00 on any day on premises authorised to sell alcohol for consumption on those premises, provided that the audience does not exceed 500.
 - o any playing of recorded music between 08.00 and 23.00 on any day, in a church hall, village hall, community hall, or other similar community premises, that is not licensed by a premises licence to sell alcohol, provided that (a) the audience does not exceed 500, and (b) the organiser gets consent for the performance from a person who is responsible for the premises.
 - o any playing of recorded music between 08.00 and 23.00 on any day, at the non-residential premises of (i) a local authority, or (ii) a school, or (iii) a hospital, provided that (a) the audience does not exceed 500, and (b) the organiser gets consent for the performance on the relevant premises from: (i) the local authority concerned, or (ii) the school proprietor or (iii) the health care provider for the hospital.

Continued from previous page...

- Dance: no licence is required for performances between 08.00 and 23.00 on any day, provided that the audience does not exceed 500. However, a performance which amounts to adult entertainment remains licensable.
- Cross activity exemptions: no licence is required between 08.00 and 23.00 on any day, with no limit on audience size for:
 - o any entertainment taking place on the premises of the local authority where the entertainment is provided by or on behalf of the local authority;
 - o any entertainment taking place on the hospital premises of the health care provider where the entertainment is provided by or on behalf of the health care provider;
 - o any entertainment taking place on the premises of the school where the entertainment is provided by or on behalf of the school proprietor; and
 - o any entertainment (excluding films and a boxing or wrestling entertainment) taking place at a travelling circus, provided that (a) it takes place within a moveable structure that accommodates the audience, and (b) that the travelling circus has not been located on the same site for more than 28 consecutive days.

Section 18 of 18

PAYMENT DETAILS

This fee must be paid to the authority. If you complete the application online, you must pay it by debit or credit card.

Variation Fees are determined by the non-domestic rateable value of the premises.

To find out a premises non domestic rateable value go to the Valuation Office Agency site at http://www.voa.gov.uk/business_rates/index.htm

Band A - No RV to £4300 £100.00

Band B - £4301 to £33000 £190.00

Band C - £33001 to £87000 £315.00

Band D - £87001 to £125000 £450.00*

Band E - £125001 and over £635.00*

*If the premises rateable value is in Bands D or E and the premises is primarily used for the consumption of alcohol on the premises then your are required to pay a higher fee

Band D - £87001 to £125000 £900.00

Band E - £125001 and over £1,905.00

If you own a large premise you are subject to additional fees based upon the number in attendance at any one time

Capacity 5000-9999 £1,000.00

Capacity 10000 -14999 £2,000.00

Capacity 15000-19999 £4,000.00

Capacity 20000-29999 £8,000.00

Capacity 30000-39999 £16,000.00

Capacity 40000-49999 £24,000.00

Capacity 50000-59999 £32,000.00

Capacity 60000-69999 £40,000.00

Capacity 70000-79999 £48,000.00

Capacity 80000-89999 £56,000.00

Capacity 90000 and over £64,000.00

* Fee amount (£)

190.00

DECLARATION

IT IS AN OFFENCE, UNDER SECTION 158 OF THE LICENSING ACT 2003, TO MAKE A FALSE STATEMENT IN OR IN CONNECTION WITH THIS APPLICATION. THOSE WHO MAKE A FALSE STATEMENT MAY BE LIABLE ON SUMMARY CONVICTION TO A FINE OF ANY AMOUNT.

Ticking this box indicates you have read and understood the above declaration

Continued from previous page...

This section should be completed by the applicant, unless you answered "Yes" to the question "Are you an agent acting on behalf of the applicant?"

* Full name	<input type="text" value="Winckworth Sherwood LLP"/>
* Capacity	<input type="text" value="Agent"/>
* Date	<input type="text" value="06"/> / <input type="text" value="06"/> / <input type="text" value="2023"/>
	dd mm yyyy

Once you're finished you need to do the following:

1. Save this form to your computer by clicking file/save as...
2. Go back to <https://www.gov.uk/apply-for-a-licence/premises-licence/islington/change-1> to upload this file and continue with your application.

Don't forget to make sure you have all your supporting documentation to hand.

IT IS AN OFFENCE, UNDER SECTION 158 OF THE LICENSING ACT 2003, TO MAKE A FALSE STATEMENT IN OR IN CONNECTION WITH THIS APPLICATION. THOSE WHO MAKE A FALSE STATEMENT MAY BE LIABLE ON SUMMARY CONVICTION TO A FINE OF ANY AMOUNT.

OFFICE USE ONLY

Applicant reference number	<input type="text" value="AGS/39096/621"/>
Fee paid	<input type="text"/>
Payment provider reference	<input type="text"/>
ELMS Payment Reference	<input type="text"/>
Payment status	<input type="text"/>
Payment authorisation code	<input type="text"/>
Payment authorisation date	<input type="text"/>
Date and time submitted	<input type="text"/>
Approval deadline	<input type="text"/>
Error message	<input type="text"/>
Is Digitally signed	<input type="checkbox"/>

[1](#) [2](#) [3](#) [4](#) [5](#) [6](#) [7](#) [8](#) [9](#) [10](#) [11](#) [12](#) [13](#) [14](#) [15](#) [16](#) [17](#) [18](#) [Next >](#)

**PREMISES LICENCE
LICENSING ACT 2003**

Premises licence number	LN/2970-12052023	Date of original grant*	24 November 2005
--------------------------------	------------------	--------------------------------	------------------

**An annual fee associated with this licence is to be paid on the anniversary of the original grant date.*

Postal address of premises, or if none, ordnance survey map reference or description M R H HORNSEY ROAD 213-217 HORNSEY ROAD			
Post town	London	Post code	N7 6RA
Telephone number	020 7272 0125		

Where the licence is time limited the dates Not Applicable
--

Licensable activities authorised by the licence
<ul style="list-style-type: none"> The sale by retail of alcohol

The times the licence authorises the carrying out of licensable activities																																			
<ul style="list-style-type: none"> The sale by retail of alcohol: <table border="0"> <tr> <td>Monday</td> <td>08:00</td> <td>to</td> <td>23:00</td> <td>the following day</td> </tr> <tr> <td>Tuesday</td> <td>08:00</td> <td>to</td> <td>23:00</td> <td>the following day</td> </tr> <tr> <td>Wednesday</td> <td>08:00</td> <td>to</td> <td>23:00</td> <td>the following day</td> </tr> <tr> <td>Thursday</td> <td>08:00</td> <td>to</td> <td>23:00</td> <td>the following day</td> </tr> <tr> <td>Friday</td> <td>08:00</td> <td>to</td> <td>23:00</td> <td>the following day</td> </tr> <tr> <td>Saturday</td> <td>08:00</td> <td>to</td> <td>23:00</td> <td>the following day</td> </tr> <tr> <td>Sunday</td> <td>08:00</td> <td>to</td> <td>23:00</td> <td>the following day</td> </tr> </table> 	Monday	08:00	to	23:00	the following day	Tuesday	08:00	to	23:00	the following day	Wednesday	08:00	to	23:00	the following day	Thursday	08:00	to	23:00	the following day	Friday	08:00	to	23:00	the following day	Saturday	08:00	to	23:00	the following day	Sunday	08:00	to	23:00	the following day
Monday	08:00	to	23:00	the following day																															
Tuesday	08:00	to	23:00	the following day																															
Wednesday	08:00	to	23:00	the following day																															
Thursday	08:00	to	23:00	the following day																															
Friday	08:00	to	23:00	the following day																															
Saturday	08:00	to	23:00	the following day																															
Sunday	08:00	to	23:00	the following day																															

Gaming Machine Provision:
None permitted

The opening hours of the premises:																																			
<table border="0"> <tr> <td>Monday</td> <td>00:00</td> <td>to</td> <td>24:00</td> <td>the following day</td> </tr> <tr> <td>Tuesday</td> <td>00:00</td> <td>to</td> <td>24:00</td> <td>the following day</td> </tr> <tr> <td>Wednesday</td> <td>00:00</td> <td>to</td> <td>24:00</td> <td>the following day</td> </tr> <tr> <td>Thursday</td> <td>00:00</td> <td>to</td> <td>24:00</td> <td>the following day</td> </tr> <tr> <td>Friday</td> <td>00:00</td> <td>to</td> <td>24:00</td> <td>the following day</td> </tr> <tr> <td>Saturday</td> <td>00:00</td> <td>to</td> <td>24:00</td> <td>the following day</td> </tr> <tr> <td>Sunday</td> <td>00:00</td> <td>to</td> <td>24:00</td> <td>the following day</td> </tr> </table>	Monday	00:00	to	24:00	the following day	Tuesday	00:00	to	24:00	the following day	Wednesday	00:00	to	24:00	the following day	Thursday	00:00	to	24:00	the following day	Friday	00:00	to	24:00	the following day	Saturday	00:00	to	24:00	the following day	Sunday	00:00	to	24:00	the following day
Monday	00:00	to	24:00	the following day																															
Tuesday	00:00	to	24:00	the following day																															
Wednesday	00:00	to	24:00	the following day																															
Thursday	00:00	to	24:00	the following day																															
Friday	00:00	to	24:00	the following day																															
Saturday	00:00	to	24:00	the following day																															
Sunday	00:00	to	24:00	the following day																															

Where the licence authorises supplies of alcohol whether these are on and/or off supplies

Off supplies

Name, (registered) address, telephone number and e-mail (where relevant) of holder of premises licence

Motor fuel Ltd
10 Bricket Road
St Albans
AL1 3JX

Registered number of holder, for example company number, charity number (where applicable)

05206547

Name, address and telephone number of designated premises supervisor where the premises licence authorises the supply of alcohol

Parameswaran Jegan

[REDACTED]
[REDACTED]
[REDACTED]
[REDACTED]

Personal licence number and issuing authority of personal licence held by designated premises supervisor where the premises licence authorises the supply of alcohol

[REDACTED]

Islington Council
Public Protection Division
222 Upper Street
London
N1 1XR
Tel: 020 7527 3031
Email: licensing@islington.gov.uk



Service Manager
Commercial & Residential

23/06/2023

Date of Issue

Annex 1 - Mandatory conditions

1. No supply of alcohol may be made under the premises licence:
 - a) at a time when there is no designated premises supervisor in respect of the premises licence, or
 - b) at a time when the designated premises supervisor does not hold a personal licence or his personal licence is suspended.
2. Every supply of alcohol under the premises licence must be made or authorised by a person who holds a personal licence.
3. All door supervisors shall be licensed by the Security Industry Authority.
4. The admission of children to the exhibition of a film shall be restricted in accordance with the recommendation of a film classification body as defined in the Video Recordings Act 1984 or Islington Council acting as the licensing authority where it has given notice in section 20(3) of the Licensing Act 2003.

There are further 'Mandatory conditions' applicable to licences authorising the supply of alcohol. A full list of the current mandatory conditions is available from the licensing pages on Islington's web site, www.islington.gov.uk. This list is subject to change by order of the Secretary of State and licensees and other responsible persons are advised to ensure they are aware of the latest conditions.

Annex 2 - Conditions consistent with the Operating Schedule

1. CCTV shall be installed, operated, and maintained, to function all times that the premises is open for licensable activities. Said CCTV will comply with the following criteria
 - (a) The licensee will ensure that the system is checked every two weeks to ensure that the system is working properly and that the date and time are correct.
 - (b) A record of these checks, showing the date and name of the person checking, will be kept and made available to the police or other authorised officer on request;
 - (c) The Police will be informed if the system will not be operating for longer than one day of business for any reason;
 - (d) One camera will show a close-up of the entrance to the premises, to capture a clear, full length image of anyone entering;
 - (e) The system will provide full coverage of the interior of the premises and any exterior part of the premises accessible to the public;
 - (f) The system will record in real time and recordings will be date and time stamped;
 - (g) The system will be specified so as to operate satisfactorily regardless of lighting conditions;
 - (h) During opening hours, at least 1 member of staff on duty will be able to operate the system sufficiently to allow Police or authorised Council officers to view footage on request;
 - (i) Recordings will be kept for a minimum of 31 days;
 - (j) Footage will be provided free of charge to the police or other authorised officers upon request (subject to the Data Protection Act 1998) within 24 hours of any request.
2. All sales of alcohol shall be in sealed containers, for consumption away from the premises only.
3. No spirit miniatures or other bottles containing alcohol below 33cl shall be sold from the premises at any time.

4. In the event that crime or serious disorder is, or appears to have been, committed on the premises, the management will immediately ensure that:

(a) the police and, where appropriate, the London Ambulance Service, are called immediately.

(b) As far as is safe and reasonable practicable, all measures will be taken to preserve any identified crime scene pending the arrival of police

5. There shall be no advertising or marketing of alcohol products in the store windows.

6. At all times that the premises is open outside the alcohol trading hours, all alcohol will be covered (ie completely obscured from view) using a suitable curtain, cabinet or shutter.

7. All sales tills will offer a Challenge 25 reminder / prompt the cashier making an alcohol sale to verify that the customer is over 18.

8. An incident log shall be kept on the premises and made available to the police or local authority upon reasonable request, which will record:

(a) Any and all allegations of crime or disorder reported at the venue

(b) Any and all complaints received by any party

(c) Any faults with the CCTV system

(d) Any visit by a relevant authority or emergency service

9. The premises shall operate the Challenge 25 proof of age scheme, whereby the only forms of acceptable identification shall be:

(a) Photographic driving licence;

(b) Valid passport;

(c) Military/ UK Services Photo ID;

(d) PASS Hologram ID;

(e) Any other form of identification from time to time approved by the secretary of the state.

10. The premises will be fitted with a burglar alarm system.

11. All staff engaged or to be engaged in the sale of alcohol on the premises shall receive training in conflict resolution, age restricted sales and recognising the signs of intoxication.

12. There will at all times be adequate levels of staff maintained at the premises. Such staff levels will be disclosed, on request, to the licensing authority and police.

Annex 3 - Conditions attached after a hearing by the licensing authority

Not applicable

Annex 4 – Plans

Reference Number: Store Number FS748 – 24.02.20

Premises Licence Summary

Licensing Act 2003

Premises licence number	LN/2970-12052023	Date of original grant*	24 November 2005
--------------------------------	------------------	--------------------------------	------------------

**An annual fee associated with this licence is to be paid on the anniversary of the original grant date.*

Postal address of premises, or if none, ordnance survey map reference or description			
M R H HORNSEY ROAD 213-217 HORNSEY ROAD			
Post town	London	Post code	N7 6RA
Telephone number	020 7272 0125		

Where the licence is time limited the dates
Not Applicable

Licensable activities authorised by the licence
<ul style="list-style-type: none"> • The sale by retail of alcohol

The times the licence authorises the carrying out of licensable activities																																			
<ul style="list-style-type: none"> • The sale by retail of alcohol: <table style="margin-left: 40px; border: none;"> <tr><td>Monday</td><td>08:00</td><td>to</td><td>23:00</td><td>the following day</td></tr> <tr><td>Tuesday</td><td>08:00</td><td>to</td><td>23:00</td><td>the following day</td></tr> <tr><td>Wednesday</td><td>08:00</td><td>to</td><td>23:00</td><td>the following day</td></tr> <tr><td>Thursday</td><td>08:00</td><td>to</td><td>23:00</td><td>the following day</td></tr> <tr><td>Friday</td><td>08:00</td><td>to</td><td>23:00</td><td>the following day</td></tr> <tr><td>Saturday</td><td>08:00</td><td>to</td><td>23:00</td><td>the following day</td></tr> <tr><td>Sunday</td><td>08:00</td><td>to</td><td>23:00</td><td>the following day</td></tr> </table>	Monday	08:00	to	23:00	the following day	Tuesday	08:00	to	23:00	the following day	Wednesday	08:00	to	23:00	the following day	Thursday	08:00	to	23:00	the following day	Friday	08:00	to	23:00	the following day	Saturday	08:00	to	23:00	the following day	Sunday	08:00	to	23:00	the following day
Monday	08:00	to	23:00	the following day																															
Tuesday	08:00	to	23:00	the following day																															
Wednesday	08:00	to	23:00	the following day																															
Thursday	08:00	to	23:00	the following day																															
Friday	08:00	to	23:00	the following day																															
Saturday	08:00	to	23:00	the following day																															
Sunday	08:00	to	23:00	the following day																															

Gaming Machine Provision:
None permitted

The opening hours of the premises:																																			
<table style="margin-left: 40px; border: none;"> <tr><td>Monday</td><td>00:00</td><td>to</td><td>24:00</td><td>the following day</td></tr> <tr><td>Tuesday</td><td>00:00</td><td>to</td><td>24:00</td><td>the following day</td></tr> <tr><td>Wednesday</td><td>00:00</td><td>to</td><td>24:00</td><td>the following day</td></tr> <tr><td>Thursday</td><td>00:00</td><td>to</td><td>24:00</td><td>the following day</td></tr> <tr><td>Friday</td><td>00:00</td><td>to</td><td>24:00</td><td>the following day</td></tr> <tr><td>Saturday</td><td>00:00</td><td>to</td><td>24:00</td><td>the following day</td></tr> <tr><td>Sunday</td><td>00:00</td><td>to</td><td>24:00</td><td>the following day</td></tr> </table>	Monday	00:00	to	24:00	the following day	Tuesday	00:00	to	24:00	the following day	Wednesday	00:00	to	24:00	the following day	Thursday	00:00	to	24:00	the following day	Friday	00:00	to	24:00	the following day	Saturday	00:00	to	24:00	the following day	Sunday	00:00	to	24:00	the following day
Monday	00:00	to	24:00	the following day																															
Tuesday	00:00	to	24:00	the following day																															
Wednesday	00:00	to	24:00	the following day																															
Thursday	00:00	to	24:00	the following day																															
Friday	00:00	to	24:00	the following day																															
Saturday	00:00	to	24:00	the following day																															
Sunday	00:00	to	24:00	the following day																															

Where the licence authorises supplies of alcohol whether these are on and/or off supplies

Off supplies

Name, (registered) address, telephone number and e-mail (where relevant) of holder of premises licence

Motor fuel Ltd
10 Bricket Road
St Albans
AL1 3JX

Registered number of holder, for example company number, charity number (where applicable)

05206547

Name of designated premises supervisor where the premises licence authorises the supply of alcohol

Parameswaran Jegan

State whether access to the premises by children is restricted or prohibited

No restrictions

Islington Council
Public Protection Division
222 Upper Street
London
N1 1XR
Tel: 020 7527 3031

Licensing Authority Representation

Licensing Act 2003

Application for Variation to a premises licence in respect of:

Motor Fuel Limited, 213-217 Hornsey Road N7 6RA

To extend the sale of alcohol off the premises commencing 0600 each day. Currently commencing at 0800.

The grounds for the representation are:

Public nuisance

Prevention of crime and disorder

Licensing Policy Considerations

Licensing Policy 2 & 3 Location, Cumulative Impact and Saturation

Licensing Policy 4 Off sales of Alcohol from Shops and other premises

Licensing Policy 5 and 6 Licensing Hours

Issues of Concern

Licensing Policy 2 & 3 – The premises is located within the Holloway and Finsbury Park Cumulative Impact Area. It is a busy commercial and residential area and Islington is committed to minimising any adverse impacts in terms of crime, disorder, nuisance, and anti-social behaviour.

Licensing Policy 4 - The Licensing Authority has adopted a special policy relating to cumulative impact in relation to shops and other premises selling alcohol for consumption off the premises. This special policy creates a rebuttable presumption that applications for premises licences, which are likely to add to the existing cumulative impact, will normally be refused or subject to certain limitation, following the receipt of representations, unless the applicant can demonstrate in the operating schedule that there will be no negative cumulative impact on one or more of the licensing objectives.

The applicant has not put forward any mitigation or information in the operating schedule to demonstrate that these premises would not have a negative impact in an area saturated with outlets for alcohol. The premises are also close to a drug and alcohol dependency unit, and it is not uncommon for users of these centres to seek out alcohol in the early hours.

Licensing Policy 5 - Where representations are received from responsible authorities or other persons the Licensing Authority may seek to restrict hours of opening where it is appropriate to promote the licensing objectives.

Licensing Policy 6 - Licensing Hours- The hours applied for are outside of the recommended policy hours for off sales of alcohol, which are from 8am to 11pm each day.

The Licensing Authority is committed to protecting the amenity of residents and businesses in the vicinity of licensed premises, and to reducing the impact on public and emergency services.

The Licensing Authority will seek to impose appropriate restrictions and controls on the premises licence to prevent public nuisance and undue disturbance to residents from licensed premises.

Recommendations

The Licensing Authority recommends that the Licensing Sub Committee consider the application and the reasons for selling alcohol at 6am, which is two hours before the recommended Policy hour of 8am. Consideration must also be given to any representations from residents and other Responsible Authorities.

Terrie Lane

Licensing Manager

Regulatory Services

0207 527 3031

licensing@islington.gov.uk

23/06/2023

From: [REDACTED]
To: [Licensing](#)
Subject: Re: MRH Hornsey Road, Commercial Unit petrol Station, N7 6RA
Date: 16 June 2023 14:32:44

[External]

Hello Kamarl

Please see below

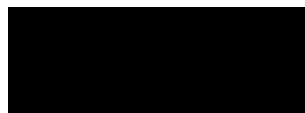

As a resident on [REDACTED] the proposed venue of the application is not acceptable, and is surrounded by residential areas and walking routes to local schools. I object to the application on all 4 counts.

The area already has a number of off licenses and convince stores, all within walking distance. A 24 hour, 7 day a week venue will add to anti social behaviour and problems for residencies and business. The noise currently generated from the petrol station causes us issues, however the current opening times gives us a some peace in the night and Sundays, changing to the proposed times will negatively impact residents.

The selling of alcohol at the proposed times will drastically increase public nuisance, crime & disorder. The area is already blighted with street drinkers who consume alcohol at all hours in residential blocks & public spaces, who then go on to litter, defecate and urinate.

I have had to change school walking routes with my children to local school due to their behaviour. The chaotic lifestyle some of the street drinkers, has also attracted open drug taking & dealing in the area. Activities which school children do not need to be exposed too, rejecting this proposal with asset in protecting local children from this harm.

A number of times the street drinkers due to their intoxicated behaviour have started fighting amongst themselves & shout profanities.

The venue is also within the Arsenal football club footprint, and this change will give a focal point to rowdy football fans to stockpile and consume alcohol after football games. The junction with Seven Sisters Road has a rehabilitation centre, and this change of licensing times would be cruel and unethical temptation to those service users trying to change their life.

Thank you

Kind Regards



Sent from my iPhone

On 16 Jun 2023, at 13:40, Licensing <Licensing@islington.gov.uk> wrote:

Dear [REDACTED]

In order for your representations to be considered you must provide us with your full address.

Kind Regards

Kamarl James

Licensing Support Officer

Licensing

Community Safety, Resilience and Security

Islington Council

222 Upper Street, N1 1XR

Licensing Duty Line: **020 7527 3031** or email licensing@islington.gov.uk

The information contained in this E-Mail may be subject to public disclosure under the Freedom of Information Act 2000. Unless the information is legally exempt from disclosure, the confidentiality of this E-Mail and your reply cannot be guaranteed. It is intended solely for the addressee. If you are not the intended recipient, any disclosure, copying, distribution or any action taken or omitted to be taken in reliance on it, is prohibited and may be unlawful.

From: [REDACTED]

Sent: 16 June 2023 11:22

To: Licensing <Licensing@islington.gov.uk>

Subject: MRH Hornsey Road, Commercial Unit petrol Station, N7 6RA

[External]

Re: MRH Hornsey Road, Commercial Unit petrol Station, Eagle House, 213-217 Hornsey Road, Islington, London N7 6RA

As a resident on [REDACTED] the proposed venue of the application is not acceptable, and is surrounded by residential areas and walking routes to local schools. I object to the application on all 4 counts.

The area already has a number of off licenses and convince stores, all within walking distance. A 24 hour, 7 day a week venue will add to anti social behaviour and problems for residencies and business. The noise currently generated from the petrol station causes us issues, however the current opening times gives us a some peace in the night and Sundays, changing to the proposed times will negatively impact residents.

The selling of alcohol at the proposed times will drastically increase public nuisance, crime & disorder. The area is already blighted with street drinkers who consume alcohol at all hours in residential blocks & public spaces, who then go on to litter, defecate and urinate.

I have had to change school walking routes with my children to local school due to their behaviour. The chaotic lifestyle some of the street drinkers, has also attracted open drug taking & dealing in the area. Activities which school children do not need to be exposed too, rejecting this proposal with asset in protecting local children from this harm.

A number of times the street drinkers due to their intoxicated behaviour have started fighting amongst themselves & shout profanities.

The venue is also within the Arsenal football club footprint, and this change will give a focal point to rowdy football fans to stockpile and consume alcohol after football games. The junction with Seven Sisters Road has a rehabilitation centre, and this change of licensing times would be cruel and unethical temptation to those service users trying to change their life.

Thank you

Kind Regards

[REDACTED]
[REDACTED]

This e-mail is intended for the addressee only. If you have received it in error, please contact the sender and delete the material from your computer. Please be aware that information in this email may be confidential, legally privileged and/or copyright protected.

From: [REDACTED]
To: [Licensing](#)
Subject: Objection to licensing variation
Date: 22 June 2023 21:36:58

[External]

To whom it may concern

Ref: MRH Hornsey Road Commercial Unit Petrol Station Eagle House 213 to 217 Hornsey Road N7 6RA

As a resident on [REDACTED], the proposed licensing variation location is surrounded by residential areas and walking routes to local schools. I object to the application on all 4 counts.

The area already has a number of off licenses and convince stores, all within walking distance. The area doesn't need yet another extended opening hours place to buy alcohol.

The noise currently generated from the petrol station is a big disturbance to our neighbours. However the current opening times gives us some peace in the night and Sundays. So a change to the proposed times will negatively impact residents.

A 24 hour, 7 day a week venue will add to anti social behaviour and problems for residencies and business. The selling of alcohol at the proposed times will increase public nuisance, crime & disorder. The area is already blighted with street drinkers who consume alcohol at all hours in residential blocks & public spaces, who then go on to litter, defecate and urinate. The chaotic lifestyle some of the street drinkers has also attracted open drug taking & dealing in the area.

The venue is also within the Arsenal football club footprint, and this change will give a focal point to rowdy football fans to stockpile and consume alcohol after football games.

Finally, the junction with Seven Sisters Road has a rehabilitation centre, and this change of licensing times would be cruel and unethical temptation to those service users trying to change their life.

Please consider my objection

Thanks [REDACTED], [REDACTED]

From: [REDACTED]
To: [Licensing](#)
Subject: M R H HORNSEY ROAD, COMMERCIAL UNIT PETROL STATION EAGELE HOUSE N7 6RA
Date: 16 June 2023 11:55:43

[External]

To whom it may concern, I am writing in relation to the above venues proposed change in licensing times. As a resident on [REDACTED], the proposed venue of the application sits behind [REDACTED], and is surrounded by residential areas and walking routes to local schools. I object to the application on all 4 counts.

The area already has a number of off licenses and convenience stores, all within walking distance. A 24 hour, 7 day a week venue will add to anti social behaviour and problems for residencies and business. The noise currently generated from the petrol station causes us issues, however the current opening times gives us some peace in the night and Sundays, changing to the proposed times will negatively impact residents.

The selling of alcohol at the proposed times will drastically increase public nuisance, crime & disorder. The area is already blighted with street drinkers who consume alcohol at all hours in residential blocks & public spaces, who then go on to litter, defecate and urinate.

I have had to change school walking routes with my children due to their behaviour. The chaotic lifestyle of some of the street drinkers, has also attracted open drug taking & dealing in the area. Activities which school children do not need to be exposed to, rejecting this proposal will assist protecting local children from this harm.

A number of times the street drinkers due to their intoxicated behaviour have started fighting amongst themselves & shout profanities.

The venue is also within the Arsenal football club footprint, and this change will give a focal point to rowdy football fans to stockpile and consume alcohol after football games. The junction with Seven Sisters Road has a rehabilitation centre, and this change of licensing times would be cruel and unethical to those service users trying to change their lives.

Please support the local residents and reject the application on its current proposed timetable.

My details are below -

[REDACTED]

Existing Conditions on the current premises licence

1. CCTV shall be installed, operated, and maintained, to function all times that the premises is open for licensable activities. Said CCTV will comply with the following criteria
 - a) The licensee will ensure that the system is checked every two weeks to ensure that the system is working properly and that the date and time are correct.
 - b) A record of these checks, showing the date and name of the person checking, will be kept, and made available to the police or other authorised officer on request.
 - c) The Police will be informed if the system will not be operating for longer than one day of business for any reason.
 - d) One camera will show a close-up of the entrance to the premises, to capture a clear, full-length image of anyone entering.
 - e) The system will provide full coverage of the interior of the premises and any exterior part of the premises accessible to the public.
 - f) The system will record in real time and recordings will be date and time stamped.
 - g) The system will be specified so as to operate satisfactorily regardless of lighting conditions.
 - h) During opening hours, at least one member of staff on duty will be able to operate the system sufficiently to allow Police or authorised Council officers to view footage on request.
 - i) Recordings will be kept for a minimum of 31 days.
 - j) Footage will be provided free of charge to the police or other authorised officers upon request (subject to the Data Protection Act 1998) within 24 hours of any request.
2. All sales of alcohol shall be in sealed containers, for consumption away from the premises only.
3. No spirit miniatures or other bottles containing alcohol below 33cl shall be sold from the premises at any time.
4. In the event that crime or serious disorder is, or appears to have been, committed on the premises, the management will immediately ensure that:
 - a) the police and, where appropriate, the London Ambulance Service, are called immediately.
 - b) As far as is safe and reasonable practicable, all measures will be taken to preserve any identified crime scene pending the arrival of police
5. There shall be no advertising or marketing of alcohol products in the store windows.
6. At all times that the premises is open outside the alcohol trading hours, all alcohol will be covered (i.e., completely obscured from view) using a suitable curtain, cabinet, or shutter.
7. All sales tills will offer a Challenge 25 reminder / prompt the cashier making an alcohol sale to verify that the customer is over eighteen.
8. An incident log shall be kept on the premises and made available to the police or local authority upon reasonable request, which will record:
 - a) Any and all allegations of crime or disorder reported at the venue
 - b) Any and all complaints received by any party

- c) Any faults with the CCTV system
 - d) Any visit by a relevant authority or emergency service
9. The premises shall operate the Challenge 25 proof of age scheme, whereby the only forms of acceptable identification shall be:
- a) Photographic driving licence.
 - b) Valid passport.
 - c) Military/ UK Services Photo ID.
 - d) PASS Hologram ID.
 - e) Any other form of identification from time to time approved by the secretary of the state.
10. The premises will be fitted with a burglar alarm system.
11. All staff engaged or to be engaged in the sale of alcohol on the premises shall receive training in conflict resolution, age restricted sales and recognising the signs of intoxication.
12. There will at all times be adequate levels of staff maintained at the premises. Such staff levels will be disclosed, on request, to the licensing authority and police.

Conditions proposed by the applicant to be added to the Premises Licence.

- 1. There shall be no sale of single cans of beer, lager, or cider from the premises.
- 2. There will be no sales/supplies of beer, lager, or cider with an ABV over 6%. save for craft or premium beers.

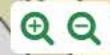
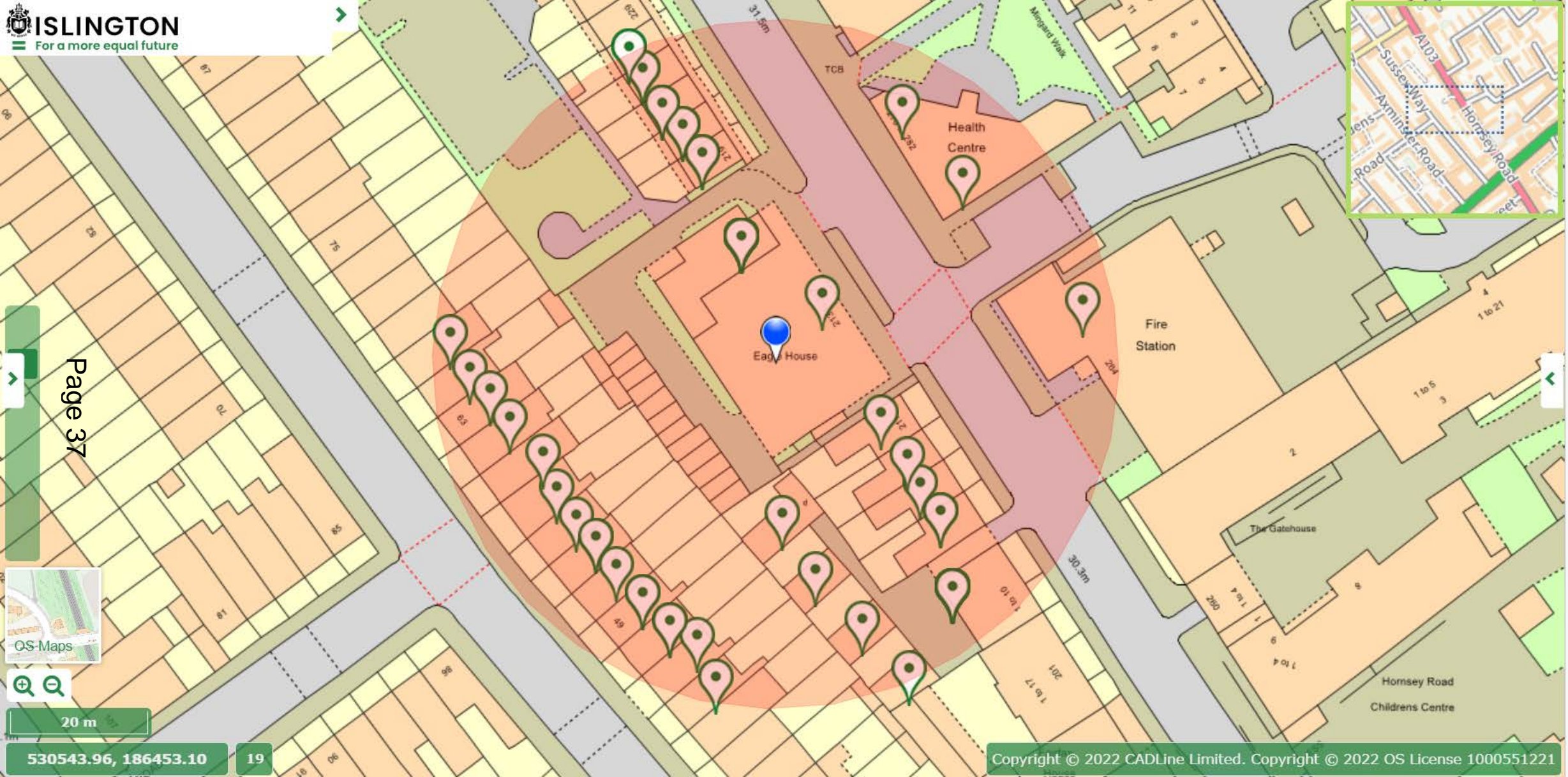

This page is intentionally left blank

Regulatory Services/Licensing
222 Upper Street, London
N1 1XR

Report of: Director Community Safety, Resilience and Security

Meeting of: Licensing Sub-Committee

Date: 01/08/2023

Ward(s): Laycock

Subject:

PREMISES LICENCE NEW APPLICATION

Re:

Amor, 139 Holloway Road, London, N7 8LX.

1. Synopsis

- 1.1. This is an application for the variation of a premise licence under the Licensing Act 2003.
- 1.2. The premises currently holds a licence allowing:
 - **The sale by retail of alcohol, on & off supplies, Mondays to Sundays from 10:00 until 22:00; and**
 - **The premises to be open to the public, Mondays to Sundays from 10:00 until 23:00.**
- 1.3. The variation application is to allow:
 - **The sale by retail of alcohol, on & off supplies, Mondays to Sundays from 12:00 until 23:00; and**
 - **The premises to be open to the public, Mondays to Sundays from 12:00 until 00:00.**

1.4. Relevant Representations:

Licensing Authority	No
Metropolitan Police	No
Noise	No: Conditions agreed
Health and Safety	No
Trading Standards	No
Public Health	No
Safeguarding Children	No
London Fire Brigade	No
Local residents	Yes: One local resident
Other bodies	No:

2. Recommendations

- 2.1. To determine the application for a variation of the premises licence under Section 34 of the Licensing Act 2003;
- 2.2. These premises are located in the Holloway Road and Finsbury Park Cumulative Impact Area therefore the Licensing Sub-Committee will need to consider Licensing Policy 3, which states that there is a presumption of refusal unless the Sub-Committee is satisfied that there will be no adverse cumulative impact on the licensing objectives.
- 2.3. If the Licensing Sub-Committee grants the application it should be subject to:
 - i. Conditions prepared by the Licensing Officer which are consistent with the Operating Schedule (see appendix 4); and
 - ii. Any conditions deemed appropriate by the Licensing Sub-Committee to promote the four licensing objectives.

3. Background

- 3.1. The premises licence was granted before a licensing sub-committee on 25th May 2021. The licensee and DPS initially named on the licence at the time of approval are still active at the time of writing this report.
- 3.2. There have been periodic reports of noise nuisance and allegations of the premises selling alcohol beyond their permitted hours over the last 6 months. While most of these complaints were not substantiated, the premises was found to be open beyond its permitted hours on 11th May 2023.
- 3.3. The licensing service engaged with the licensee in response to this breach and ensured that management were aware of their licensable hours and related conditions. The licensee wished to extend the terminal hour for sale of alcohol and opening hours so was given advice regarding the premises licence variation process.
- 3.4. This premises licence variation application was subsequently received by the Council's licensing service on 12th June 2023.
- 3.5. The Council's noise service submitted a representation in response to the application however, this was withdrawn based on agreed conditions of approval. These conditions are detailed at Appendix 4 of this report.
- 3.6. At the end of the consultation process there was one remaining representation from a local resident. This representation is detailed at Appendix 3 of this report.

4. Implications

4.1. Financial Implications

- 4.1.1. The Head of Finance reports that the applicant has paid the application fee of £190.00. Should the application be refused, the fee is not refundable.

4.2. Legal Implications

- 4.2.1. The legal implications are set out in Paragraph 2.
- 4.2.2. Legal advice will be provided at the meeting of the Licensing Sub-Committee as necessary.

4.3. Environmental Implications and contribution to achieving a net zero carbon Islington by 2030

4.3.1. The Licensing Sub-Committee need to consider the impacts that that proposals will have on the environment. An impact is defined as any change to the environment, whether positive or negative, wholly or partially resulting from Council activities. Almost all human activity has some impact on the environment, and it is very unlikely that any activity will not have any implications.

4.4. Equalities Impact Assessment

4.4.1. The council must, in the exercise of its functions, have due regard to the need to eliminate discrimination, harassment and victimisation, and to advance equality of opportunity, and foster good relations, between those who share a relevant protected characteristic and those who do not share it (section 149 Equality Act 2010). The council has a duty to have due regard to the need to remove or minimise disadvantages, take steps to meet needs, in particular steps to take account of disabled persons' disabilities, and encourage people to participate in public life. The council must have due regard to the need to tackle prejudice and promote understanding.

4.4.2. An Equalities Impact Assessment is not required in relation to this report, because this is a decision relating to a Premises Licence application under the Licensing Act 2003.

4.5. Planning implications

4.5.1. The property is not a listed building but it is located in the St Mary Magdalene Conservation Area.

4.5.2. The property has a long established use for retail purposes.

4.5.3. However, planning law was changed by the government on 1 September 2020 by virtue of the Town and Country Planning (Use Classes) (Amendment) (England) Regulations 2020. This changed the use classes order 1987 that created a new Class E that incorporates retail, cafes, restaurants and offices etc.

4.5.4. On this basis, the use noted in the license application would not be in breach of planning control. There is no objection.

5. Conclusion and reasons for recommendations

5.1. That the Licensing Sub-Committee determines this application.

Appendices:

Appendix 1: application form;

Appendix 2: current premises licence;

Appendix 3: representations;

Appendix 4: suggested conditions and map of premises location.

Background papers:

- None.

Final report clearance:

Authorised by:

Terrie Lane

Licensing Manager

Date:

20th July 2023

Report author: Licensing Service

Tel: 020 75027 3031

E-mail: licensing@islington.gov.uk



Application to vary a premises licence under the Licensing Act 2003

PLEASE READ THE FOLLOWING INSTRUCTIONS FIRST

Before completing this form please read the guidance notes at the end of the form. If you are completing this form by hand please write legibly in block capitals. In all cases ensure that your answers are inside the boxes and written in black ink. Use additional sheets if necessary.

You may wish to keep a copy of the completed form for your records.

I/We MICHELE FANELLI

(Insert name(s) of applicant)

being the premises licence holder, apply to vary a premises licence under section 34 of the Licensing Act 2003 for the premises described in Part 1 below

Premises licence number

LN/208234-200721

Part 1 – Premises Details

Postal address of premises or, if none, ordnance survey map reference or description
139 HOLLOWAY ROAD ISLINGTON LONDON

Post town

Postcode

N78LX

Telephone number at premises (if any)

02037307443

Non-domestic rateable value of premises

£

Part 2 – Applicant details

Daytime contact
telephone number

E-mail address (optional)

Current postal address if different
from premises address

Post town

Postcode

Part 3 - Variation

Please tick as appropriate

Do you want the proposed variation to have effect as soon as possible?

Yes

No

If not, from what date do you want the variation to take effect?

DD	MM	YYYY
1	0	062023

Please describe briefly the nature of the proposed variation (Please see guidance note 1)

THE SALE BY RETAIL OF ALCOHOL:
MONDAY TO SUNDAY FROM 12:00 TO 23:00

THE OPENING HOURS OF THE PREMISES:
MONDAY TO SUNDAY FROM 12:00 TO 24:00

If your proposed variation would mean that 5,000 or more people are expected to attend the premises at any one time, please state the number expected to attend:

Part 4 Operating Schedule

Please complete those parts of the Operating Schedule below which would be subject to change if this application to vary is successful.

Provision of regulated entertainment

Please tick all that apply

- a) plays (if ticking yes, fill in box A)
- b) films (if ticking yes, fill in box B)
- c) indoor sporting events (if ticking yes, fill in box C)
- d) boxing or wrestling entertainment (if ticking yes, fill in box D)
- e) live music (if ticking yes, fill in box E)
- f) recorded music (if ticking yes, fill in box F)
- g) performances of dance (if ticking yes, fill in box G)
- h) anything of a similar description to that falling within (e), (f) or (g) (if ticking yes, fill in box H)

Provision of late night refreshment (if ticking yes, fill in box I)

Sale by retail of alcohol (if ticking yes, fill in box J)

In all cases complete boxes K, L and M

A

Plays Standard days and timings (please read guidance note 6)			<u>Will the performance of a play take place indoors or outdoors or both – please tick</u> (please read guidance note 2)	Indoors	<input type="checkbox"/>
				Outdoors	<input type="checkbox"/>
				Both	<input type="checkbox"/>
Day	Start	Finish	<u>Please give further details here</u> (please read guidance note 3)		
Mon					
Tue			<u>State any seasonal variations for performing plays</u> (please read guidance note 4)		
Wed					
Thur			<u>Non standard timings. Where you intend to use the premises for the performance of plays at different times to those listed in the column on the left, please list</u> (please read guidance note 5)		
Fri					
Sat					
Sun					

B

Films Standard days and timings (please read guidance note 6)			<u>Will the exhibition of films take place indoors or outdoors or both – please tick</u> (please read guidance note 2)	Indoors	<input type="checkbox"/>			
				Outdoors	<input type="checkbox"/>			
				Both	<input type="checkbox"/>			
Day	Start	Finish	<u>Please give further details here</u> (please read guidance note 3)					
Mon								
Tue								
Wed						<u>State any seasonal variations for the exhibition of films</u> (please read guidance note 4)		
Thur								
Fri						<u>Non standard timings. Where you intend to use the premises for the exhibition of films at different times to those listed in the column on the left, please list</u> (please read guidance note 5)		
Sat								
Sun								

C

Indoor sporting events Standard days and timings (please read guidance note 6)			<u>Please give further details</u> (please read guidance note 3)
Day	Start	Finish	
Mon			<u>State any seasonal variations for indoor sporting events</u> (please read guidance note 4)
Tue			
Wed			
Thur			<u>Non standard timings. Where you intend to use the premises for indoor sporting events at different times to those listed in the column on the left, please list</u> (please read guidance note 5)
Fri			
Sat			
Sun			

D

Boxing or wrestling entertainments Standard days and timings (please read guidance note 6)			<u>Will the boxing or wrestling entertainment take place indoors or outdoors or both – please tick</u> (please read guidance note 2)	Indoors	<input type="checkbox"/>			
				Outdoors	<input type="checkbox"/>			
				Both	<input type="checkbox"/>			
Day	Start	Finish	<u>Please give further details here</u> (please read guidance note 3)					
Mon								
Tue								
Wed						<u>State any seasonal variations for boxing or wrestling entertainment</u> (please read guidance note 4)		
Thur								
Fri						<u>Non standard timings. Where you intend to use the premises for boxing or wrestling entertainment at different times to those listed in the column on the left, please list</u> (please read guidance note 5)		
Sat								
Sun								

E

Live music Standard days and timings (please read guidance note 6)			<u>Will the performance of live music take place indoors or outdoors or both – please tick</u> (please read guidance note 2)	Indoors	<input type="checkbox"/>			
				Outdoors	<input type="checkbox"/>			
				Both	<input type="checkbox"/>			
Day	Start	Finish	<u>Please give further details here</u> (please read guidance note 3)					
Mon								
Tue								
Wed						<u>State any seasonal variations for the performance of live music</u> (please read guidance note 4)		
Thur								
Fri						<u>Non standard timings. Where you intend to use the premises for the performance of live music at different times to those listed in the column on the left, please list</u> (please read guidance note 5)		
Sat								
Sun								

F

Recorded music Standard days and timings (please read guidance note 6)			<u>Will the playing of recorded music take place indoors or outdoors or both – please tick</u> (please read guidance note 2)	Indoors	<input checked="" type="checkbox"/>			
				Outdoors	<input type="checkbox"/>			
				Both	<input type="checkbox"/>			
Day	Start	Finish	<u>Please give further details here</u> (please read guidance note 3)					
Mon								
Tue								
Wed						<u>State any seasonal variations for the playing of recorded music</u> (please read guidance note 4)		
Thur								
Fri						<u>Non standard timings. Where you intend to use the premises for the playing of recorded music at different times to those listed in the column on the left, please list</u> (please read guidance note 5)		
Sat								
Sun								

G

Performances of dance Standard days and timings (please read guidance note 6)			<u>Will the performance of dance take place indoors or outdoors or both – please tick</u> (please read guidance note 2)	Indoors	<input type="checkbox"/>
				Outdoors	<input type="checkbox"/>
				Both	<input type="checkbox"/>
Day	Start	Finish			
Mon			<u>Please give further details here</u> (please read guidance note 3)		
Tue					
Wed			<u>State any seasonal variations for the performance of dance</u> (please read guidance note 4)		
Thur					
Fri			<u>Non standard timings. Where you intend to use the premises for the performance of dance at different times to those listed in the column on the left, please list</u> (please read guidance note 5)		
Sat					
Sun					

H

<p>Anything of a similar description to that falling within (e), (f) or (g) Standard days and timings (please read guidance note 6)</p>			<p>Please give a description of the type of entertainment you will be providing</p>		
Day	Start	Finish	<p><u>Will this entertainment take place indoors or outdoors or both – please tick</u> (please read guidance note 2)</p>	Indoors	<input type="checkbox"/>
Mon				Outdoors	<input type="checkbox"/>
				Both	<input type="checkbox"/>
Tue			<p><u>Please give further details here</u> (please read guidance note 3)</p>		
Wed					
Thur			<p><u>State any seasonal variations for entertainment of a similar description to that falling within (e), (f) or (g)</u> (please read guidance note 4)</p>		
Fri					
Sat			<p><u>Non standard timings. Where you intend to use the premises for the entertainment of a similar description to that falling within (e), (f) or (g) at different times to those listed in the column on the left, please list</u> (please read guidance note 5)</p>		
Sun					

I

Late night refreshment Standard days and timings (please read guidance note 6)			<u>Will the provision of late night refreshment take place indoors or outdoors or both – please tick</u> (please read guidance note 2)	Indoors	<input type="checkbox"/>
				Outdoors	<input type="checkbox"/>
				Both	<input type="checkbox"/>
Day	Start	Finish			
Mon			<u>Please give further details here</u> (please read guidance note 3)		
Tue					
Wed			<u>State any seasonal variations for the provision of late night refreshment</u> (please read guidance note 4)		
Thur					
Fri			<u>Non standard timings. Where you intend to use the premises for the provision of late night refreshment at different times, to those listed in the column on the left, please list</u> (please read guidance note 5)		
Sat					
Sun					

J

Supply of alcohol Standard days and timings (please read guidance note 6)			Will the supply of alcohol be for consumption – please tick (please read guidance note 7)	On the premises	<input type="checkbox"/>
				Off the premises	<input type="checkbox"/>
				Both	<input checked="" type="checkbox"/>
Day	Start	Finish	State any seasonal variations for the supply of alcohol (please read guidance note 4)		
Mon	12	23			
Tue	12	23			
Wed	12	23			
Thur	12	23			
Fri	12	23			
Sat	12	23			
Sun	12	23	Non-standard timings. Where you intend to use the premises for the supply of alcohol at different times to those listed in the column on the left, please list (please read guidance note 5)		

K

<p>Please highlight any adult entertainment or services, activities, other entertainment or matters ancillary to the use of the premises that may give rise to concern in respect of children (please read guidance note 8).</p>

L

Hours premises are open to the public Standard days and timings (please read guidance note 6)			<u>State any seasonal variations</u> (please read guidance note 4)
Day	Start	Finish	
Mon	12	24	
	-----	-----	
Tue	12	24	
	-----	-----	
Wed	12	24	
	-----	-----	
Thur	12	24	
	-----	-----	
Fri	12	24	
	-----	-----	
Sat	12	24	
	-----	-----	
Sun	12	24	
	-----	-----	
			<u>Non standard timings. Where you intend the premises to be open to the public at different times from those listed in the column on the left, please list</u> (please read guidance note 5)

Please identify those conditions currently imposed on the licence which you believe could be removed as a consequence of the proposed variation you are seeking.

Please tick as appropriate

- I have enclosed the premises licence
- I have enclosed the relevant part of the premises licence

If you have not ticked one of these boxes, please fill in reasons for not including the licence or part of it below

Reasons why I have not enclosed the premises licence or relevant part of premises licence.

M

Describe any additional steps you intend to take to promote the four licensing objectives as a result of the proposed variation:

a) General – all four licensing objectives (b, c, d and e) (please read guidance note 9)

b) The prevention of crime and disorder

c) Public safety

d) The prevention of public nuisance

e) The protection of children from harm

Checklist:

Please tick to indicate agreement

- I have made or enclosed payment of the fee.
- I have sent copies of this application and the plan to responsible authorities and others where applicable.
- I understand that I must now advertise my application.
- I have enclosed the premises licence or relevant part of it or explanation.
- I understand that if I do not comply with the above requirements my application will be rejected.

IT IS AN OFFENCE, LIABLE ON SUMMARY CONVICTION TO A FINE NOT EXCEEDING LEVEL 5 ON THE STANDARD SCALE, UNDER SECTION 158 OF THE LICENSING ACT 2003, TO MAKE A FALSE STATEMENT IN OR IN CONNECTION WITH THIS APPLICATION.

Part 5 – Signatures (please read guidance note 10)

Signature of applicant (the current premises licence holder) or applicant’s solicitor or other duly authorised agent (please read guidance note 11). **If signing on behalf of the applicant, please state in what capacity.**

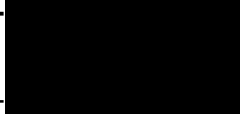
Signature	
Date	10/06/2023
Capacity	DPS DIRECTOR

Where the premises licence is jointly held, signature of 2nd applicant (the current premises licence holder) or 2nd applicant’s solicitor or other authorised agent (please read guidance note 12). **If signing on behalf of the applicant, please state in what capacity.**

Signature	
Date	
Capacity	

Contact name (where not previously given) and address for correspondence associated with this application (please read guidance note 13)

MICHELE FANELLI

Post town		Post code	N78LT
Telephone number (if any)			
If you would prefer us to correspond with you by e-mail, your e-mail address (optional)			
			

Notes for Guidance

This application cannot be used to vary the licence so as to extend the period for which the licence has effect or to vary substantially the premises to which it relates. If you wish to make that type of change to the premises licence, you should make a new premises licence application under section 17 of the Licensing Act 2003.

1. Describe the premises. For example the type of premises, its general situation and layout and any other information which could be relevant to the licensing objectives. Where your application includes off-supplies of alcohol and you intend to provide a place for consumption of these off-supplies, you must include a description of where the place will be and its proximity to the premises.
2. Where taking place in a building or other structure please tick as appropriate (indoors may include a tent).
3. For example state type of activity to be authorised, if not already stated, and give relevant further details, for example (but not exclusively) whether or not music will be amplified or unamplified.
4. For example (but not exclusively), where the activity will occur on additional days during the summer months.
5. For example (but not exclusively), where you wish the activity to go on longer on a particular day e.g. Christmas Eve.
6. Please give timings in 24 hour clock (e.g. 16:00) and only give details for the days of the week when you intend the premises to be used for the activity.
7. If you wish people to be able to consume alcohol on the premises, please tick 'on the premises'. If you wish people to be able to purchase alcohol to consume away from the premises, please tick 'off the premises'. If you wish people to be able to do both, please tick 'both'.
8. Please give information about anything intended to occur at the premises or ancillary to the use of the premises which may give rise to concern in respect of children regardless of whether you intend children to have access to the premises, for example (but not exclusively) nudity or semi-nudity, films for restricted age groups or the presence of gaming machines.
9. Please list here steps you will take to promote all four licensing objectives together.
10. The application form must be signed.
11. An applicant's agent (for example solicitor) may sign the form on their behalf provided that they have actual authority to do so.
12. Where there is more than one applicant, each of the applicants or their respective agents must sign the application form.
13. This is the address which we shall use to correspond with you about this application.

**PREMISES LICENCE
LICENSING ACT 2003**

Premises licence number	LN/20824-200721	Date of original grant*	25th May 2021
--------------------------------	------------------------	--------------------------------	---------------------------------

**An annual fee associated with this licence is to be paid on the anniversary of the original grant date.*

Postal address of premises, or if none, ordnance survey map reference or description			
AMOR 139 HOLLOWAY ROAD			
Post town	London	Post code	N7 8LX
Telephone number			

Where the licence is time limited the dates
Not Applicable

Licensable activities authorised by the licence
<ul style="list-style-type: none"> The sale by retail of alcohol

The times the licence authorises the carrying out of licensable activities																												
<ul style="list-style-type: none"> The sale by retail of alcohol: <table> <tr><td>Monday</td><td>10:00</td><td>to</td><td>22:00</td></tr> <tr><td>Tuesday</td><td>10:00</td><td>to</td><td>22:00</td></tr> <tr><td>Wednesday</td><td>10:00</td><td>to</td><td>22:00</td></tr> <tr><td>Thursday</td><td>10:00</td><td>to</td><td>22:00</td></tr> <tr><td>Friday</td><td>10:00</td><td>to</td><td>22:00</td></tr> <tr><td>Saturday</td><td>10:00</td><td>to</td><td>22:00</td></tr> <tr><td>Sunday</td><td>10:00</td><td>to</td><td>22:00</td></tr> </table> 	Monday	10:00	to	22:00	Tuesday	10:00	to	22:00	Wednesday	10:00	to	22:00	Thursday	10:00	to	22:00	Friday	10:00	to	22:00	Saturday	10:00	to	22:00	Sunday	10:00	to	22:00
Monday	10:00	to	22:00																									
Tuesday	10:00	to	22:00																									
Wednesday	10:00	to	22:00																									
Thursday	10:00	to	22:00																									
Friday	10:00	to	22:00																									
Saturday	10:00	to	22:00																									
Sunday	10:00	to	22:00																									

Gaming Machine Provision:
Not authorised

The opening hours of the premises:																												
<table> <tr><td>Monday</td><td>10:00</td><td>to</td><td>23:00</td></tr> <tr><td>Tuesday</td><td>10:00</td><td>to</td><td>23:00</td></tr> <tr><td>Wednesday</td><td>10:00</td><td>to</td><td>23:00</td></tr> <tr><td>Thursday</td><td>10:00</td><td>to</td><td>23:00</td></tr> <tr><td>Friday</td><td>10:00</td><td>to</td><td>23:00</td></tr> <tr><td>Saturday</td><td>10:00</td><td>to</td><td>23:00</td></tr> <tr><td>Sunday</td><td>10:00</td><td>to</td><td>23:00</td></tr> </table>	Monday	10:00	to	23:00	Tuesday	10:00	to	23:00	Wednesday	10:00	to	23:00	Thursday	10:00	to	23:00	Friday	10:00	to	23:00	Saturday	10:00	to	23:00	Sunday	10:00	to	23:00
Monday	10:00	to	23:00																									
Tuesday	10:00	to	23:00																									
Wednesday	10:00	to	23:00																									
Thursday	10:00	to	23:00																									
Friday	10:00	to	23:00																									
Saturday	10:00	to	23:00																									
Sunday	10:00	to	23:00																									

Where the licence authorises supplies of alcohol whether these are on and/or off supplies

On and off supplies

Name, (registered) address, telephone number and e-mail (where relevant) of holder of premises licence

Barletta Catering UK Ltd
27 Old Gloucester Street
London
WC1N 3AX.

Registered number of holder, for example company number, charity number (where applicable)

12637945

Name, address and telephone number of designated premises supervisor where the premises licence authorises the supply of alcohol

Michele Fanelli

██████
██████████████████
██████
██████

Personal licence number and issuing authority of personal licence held by designated premises supervisor where the premises licence authorises the supply of alcohol

██

Islington Council
Public Protection Division
222 Upper Street
London
N1 1XR
Tel: 020 7527 3031
Email: licensing@islington.gov.uk

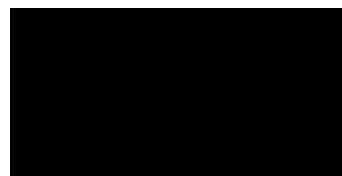

Service Manager
Commercial & Residential

25/08/2021

Date of Issue

Annex 1 - Mandatory conditions

1. No supply of alcohol may be made under the premises licence:
 - a) at a time when there is no designated premises supervisor in respect of the premises licence, or
 - b) at a time when the designated premises supervisor does not hold a personal licence or his personal licence is suspended.
2. Every supply of alcohol under the premises licence must be made or authorised by a person who holds a personal licence.
3. All door supervisors shall be licensed by the Security Industry Authority.
4. The admission of children to the exhibition of a film shall be restricted in accordance with the recommendation of a film classification body as defined in the Video Recordings Act 1984 or Islington Council acting as the licensing authority where it has given notice in section 20(3) of the Licensing Act 2003.

There are further 'Mandatory conditions' applicable to licences authorising the supply of alcohol. A full list of the current mandatory conditions is available from the licensing pages on Islington's web site, www.islington.gov.uk. This list is subject to change by order of the Secretary of State and licensees and other responsible persons are advised to ensure they are aware of the latest conditions.

Annex 2 - Conditions consistent with the Operating Schedule

1. The premises shall only operate as a delicatessen and cafe which provides food in the form of substantial meals that are prepared on the premises.
2. Substantial food shall be available throughout the premises and menus shall be displayed.
3. Alcohol for consumption on the premises or at any tables lawfully placed on the highway outside the premises will only be served to customers seated at a table by Waiter or waitress service.
4. The premises licence holder shall ensure that CCTV cameras and recorders are installed at the premises and are of a standard acceptable to and approved by the Police.:
 - a) The system shall be maintained in good working order and at all times the premises is open to the public, be fully operational covering both internal and external areas of the premises to which the public have access;
 - b) One CCTV camera shall be positioned to cover the entrance/exit in order to capture clear, facial images of all persons entering/leaving the premises;
 - c) The CCTV camera views shall not be obstructed;
 - d) The medium on which CCTV images are recorded shall be of evidential quality; stored securely; shall be retained for a period of 31 days; and be available for inspection by the Police or Local Authority upon request;
 - e) At all times when the premises are open for the purposes of licensable activities, subject to the Data Protection Act 2018, a suitably trained member of staff shall be available to assist the Police or an authorised officer in obtaining the CCTV footage;
 - f) Subject to the Data Protection Act 2018, copies shall be made available within 48 hours to the Police or Local Authority, upon request;
 - g) The facility to transfer the images to a compatible, removable format, shall be held on the premises;

- h) At least one member of working staff at the premises shall be trained in the use of CCTV and a log will be kept to verify this; and
 - i) Signs shall be displayed in the customer areas to advise that CCTV is in operation.
5. Notices shall be displayed within the premises warning customers about personal thefts; and to be vigilant.
 6. When the venue is open for licensable activities, the toilet shall be checked by staff at least every two hours and these checks are to be documented on each visit.
 7. The licensee shall adopt a 'Challenge 25' policy and promote it through the prominent display of posters. Only suitable forms of photographic identification, such as passport or UK driving licence or a holographically marked PASS scheme cards, will be accepted.
 8. The licensee shall ensure that staff are trained about age restricted products and ensure that they sign to confirm that they have understood the training.
 9. The licensee shall ensure that staff are trained, as appropriate, in respect of relevant Licensing Law; crime scene best practice and upon the sale of alcohol to drunks. and to persons underage.
 10. The licensee shall keep records of training and instructions given to staff, detailing the areas covered, and make them available for inspection upon request by the licensing team, police or trading standards.
 11. The licensee shall require staff to note any refusals to sell to young people in a refusals log. The refusals log shall be made available for inspection upon request by the licensing team, police or trading standards.
 12. All sales of alcohol for consumption off the premises shall be in sealed containers except to persons seated at tables lawfully placed on the highway.
 13. Staff shall ensure a quiet, safe dispersal of customers, with appropriate signage requesting customers to respect neighbouring residents and businesses.
 14. An incident log shall be kept at the premises and made available on request to an authorised officer of the Council or the Police, which will record the following:
 - a) all crimes reported to the venue;
 - b) all ejections of patrons;
 - c) any complaints received;
 - d) any incidents of disorder;
 - e) all seizures of drugs or offensive weapons;
 - f) any refusal of the sale of alcohol see condition 25 on refusals log; and
 - g) any visit by a relevant authority or emergency service.
 15. No noise shall emanate from the premises nor vibration be transmitted through the structure of the premises which gives rise to a nuisance.
 16. There shall be no promotions that encourage illegal, irresponsible or immoderate consumption of alcohol.
 17. Should alcohol deliveries apply, the premises licence holder shall ensure that any third party deliver/courier company is instructed to comply with the following:

- a) Any refusals will be logged by the delivery driver. Records of all refusals will be obtained from the delivery company and provided to the relevant authorities upon request; and
 - b) Couriers will be trained on relevant aspects of the Licensing Act 2003 including underage sales, sales to a person who is drunk, obtaining alcohol for a child or a person who is drunk and delivering alcohol to someone under the age of 18.
18. In the event that an assault is committed on the premises (or appears to have been committed) the management will immediately ensure that:
- a) The police (and, where appropriate, the London Ambulance Service) are called without delay;
 - b) The crime scene is preserved so as to enable a full forensic investigation to be carried out by the police; and
 - c) Such other measures are taken (as appropriate) to fully protect the safety of all persons present on the premises.
19. The delivery of licensable goods to the premises shall be restricted to the hours between 07:00 and 23:00 Monday-Saturday. No deliveries to the premises shall be made on a Sunday or Bank Holiday.
20. Alcohol shall not be sold or supplied on the premises otherwise than to persons purchasing food there and for consumption by such a person as an ancillary to their meal.
21. The shutters to the front of the premises shall be maintained so as not to cause a noise nuisance when in operation to residential properties in close vicinity.
22. The outside frontage shall be swept and cleared of any rubbish and smoking litter associated with the business at the end of trade each evening.
23. The outside of the premises shall be regularly monitored to ensure that noise levels from patrons do not cause a nuisance to any nearby residents.
24. Any outdoor furniture shall be fitted with rubber pads to the bottom of the legs to minimise noise when moved.

Annex 3 - Conditions attached after a hearing by the licensing authority

1. There be no off sale deliveries of alcohol.

Annex 4 – Plans

Reference Number: Holloway001-AB-March2021

Premises Licence Summary

Licensing Act 2003

Premises licence number	LN/20824-200721	Date of original grant*	25 th May 2021
--------------------------------	-----------------	--------------------------------	---------------------------

**An annual fee associated with this licence is to be paid on the anniversary of the original grant date.*

Postal address of premises, or if none, ordnance survey map reference or description			
AMOR 139 HOLLOWAY ROAD			
Post town	London	Post code	N7 8LX
Telephone number			

Where the licence is time limited the dates
Not Applicable

Licensable activities authorised by the licence
<ul style="list-style-type: none"> • The sale by retail of alcohol

The times the licence authorises the carrying out of licensable activities																												
<ul style="list-style-type: none"> • The sale by retail of alcohol: <table style="margin-left: 40px; border: none;"> <tr> <td>Monday</td> <td>10:00</td> <td>to</td> <td>22:00</td> </tr> <tr> <td>Tuesday</td> <td>10:00</td> <td>to</td> <td>22:00</td> </tr> <tr> <td>Wednesday</td> <td>10:00</td> <td>to</td> <td>22:00</td> </tr> <tr> <td>Thursday</td> <td>10:00</td> <td>to</td> <td>22:00</td> </tr> <tr> <td>Friday</td> <td>10:00</td> <td>to</td> <td>22:00</td> </tr> <tr> <td>Saturday</td> <td>10:00</td> <td>to</td> <td>22:00</td> </tr> <tr> <td>Sunday</td> <td>10:00</td> <td>to</td> <td>22:00</td> </tr> </table> 	Monday	10:00	to	22:00	Tuesday	10:00	to	22:00	Wednesday	10:00	to	22:00	Thursday	10:00	to	22:00	Friday	10:00	to	22:00	Saturday	10:00	to	22:00	Sunday	10:00	to	22:00
Monday	10:00	to	22:00																									
Tuesday	10:00	to	22:00																									
Wednesday	10:00	to	22:00																									
Thursday	10:00	to	22:00																									
Friday	10:00	to	22:00																									
Saturday	10:00	to	22:00																									
Sunday	10:00	to	22:00																									

Gaming Machine Provision:
Not authorised

The opening hours of the premises:

Monday	10:00	to	23:00
Tuesday	10:00	to	23:00
Wednesday	10:00	to	23:00
Thursday	10:00	to	23:00
Friday	10:00	to	23:00
Saturday	10:00	to	23:00
Sunday	10:00	to	23:00

Where the licence authorises supplies of alcohol whether these are on and/or off supplies

On and off supplies

Name, (registered) address, telephone number and e-mail (where relevant) of holder of premises licence

Barletta Catering UK Ltd
27 Old Gloucester Street
London
WC1N 3AX.

Registered number of holder, for example company number, charity number (where applicable)

12637945

Name, address and telephone number of designated premises supervisor where the premises licence authorises the supply of alcohol

Michele Fanelli

State whether access to the premises by children is restricted or prohibited

No restrictions

Islington Council
Public Protection Division
222 Upper Street
London
N1 1XR
Tel: 020 7527 3031

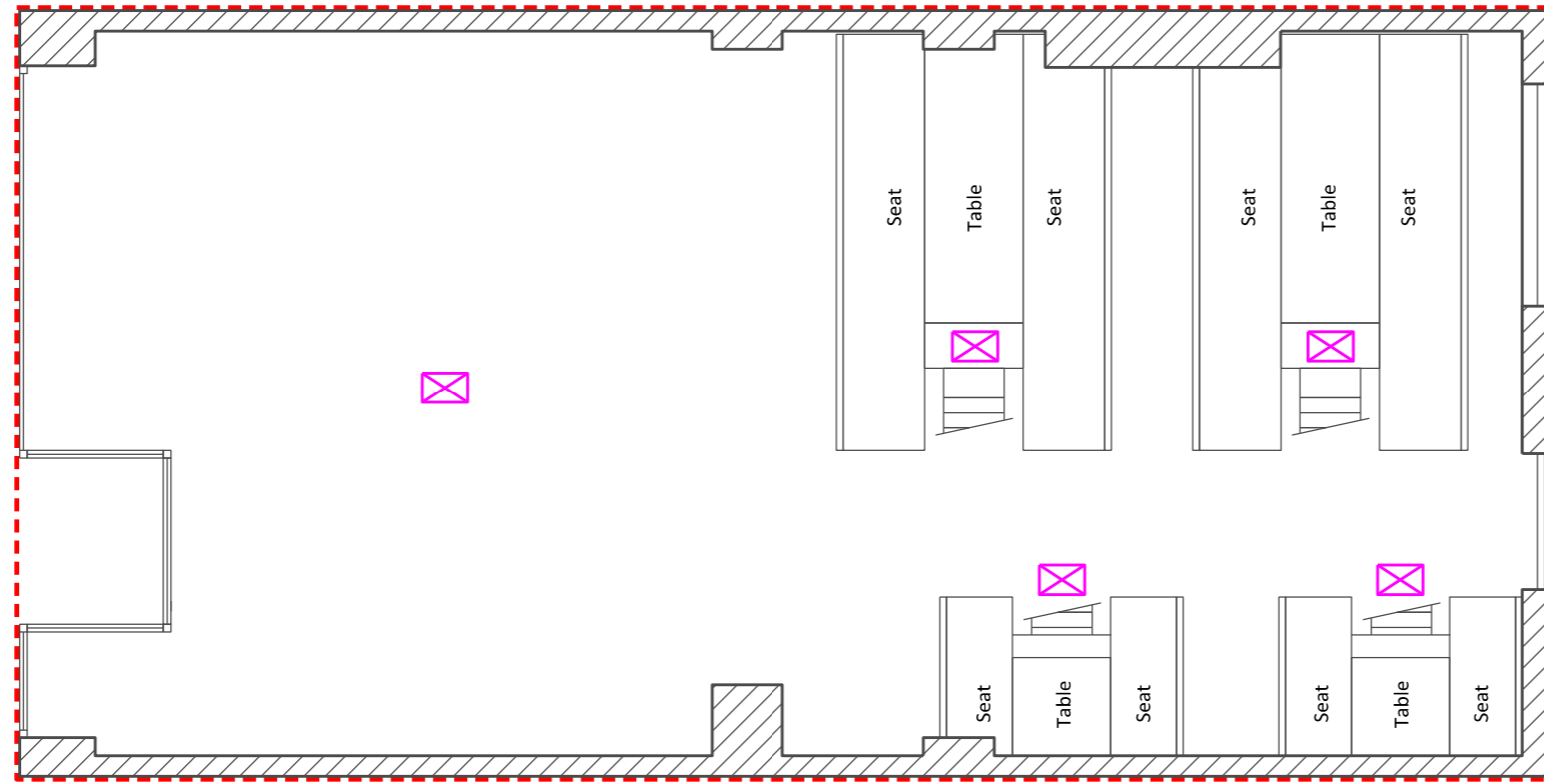

Mezzanine level

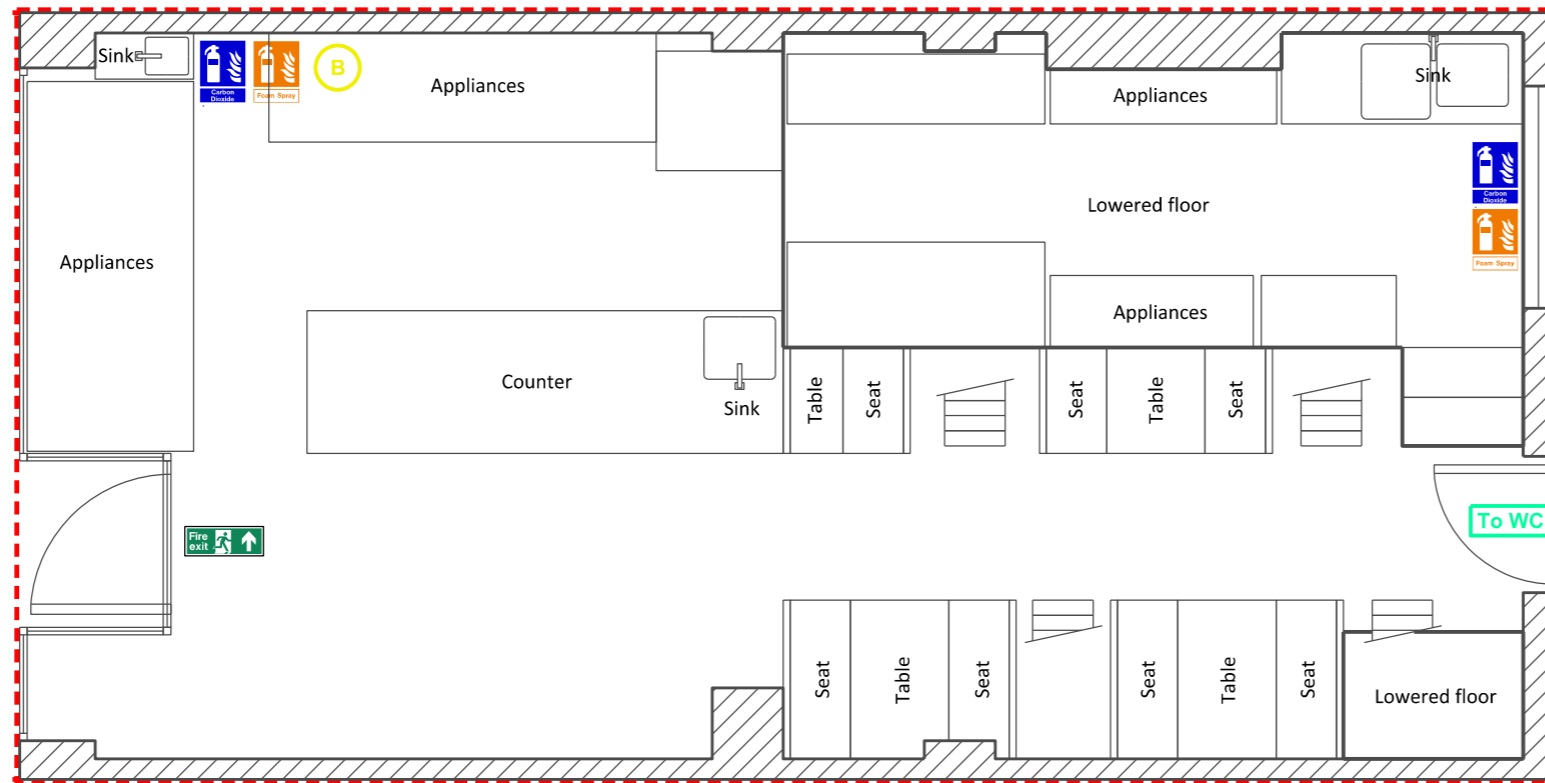





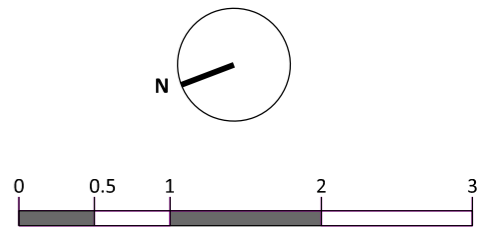

Ground floor

Please note:
Do not scale from this drawing
Use figured dimensions only
All dimensions to be checked on site & any discrepancies to be reported to the architect before any work commences



1:50 @ A3

-  Emergency Lighting
-  2kg CO2 extinguisher
-  9L AAF Foam extinguisher
-  Fire blanket
-  S22 Exit Sign (illuminated)
-  Toilet Signage
-  Ambit of licensed area

Rev.	Description	Date
Project 139 Holloway Road		
Drawing Fire Compliance		
Scale 1-50 @ A3	Date March 2021	
Purpose	Drawn AB	
Drawing No. Holloway001	Revision -	



Licensing Act 2003 representation pro-forma

Should you wish to comment on the licence application please use this form to help you.
Please feel free to attach additional sheets.

You do not have to make any comment, and comments may be made in support of as well as against the application, providing they refer to one or more of the licensing objectives (please see the guidance notes for further advice).

Premises Name and address: Amor, 139 Holloway Road, Islington, London, N7 8LX

Your Name: _____

Interest: Resident

(E.g. resident, business, TRA Chair, Councillor, solicitor)

Your Address:

Email: _____

Telephone: _____

Please comment on the licensing objectives below relevant to your concerns or observations, you may also wish to include suggestions how your concerns could be addressed:

Public Nuisance

The business generates a lot of noise playing loud music, singing, shouting. There is particularly noise around closing time people leaving and closing shutters. It is directly below residential units and bedrooms. The noise keeps us awake. The premises are within a cumulative impact area and so hours should not be extended.

Crime and Disorder

Protection of Children from Harm

Public Safety

I wish my identity to be kept anonymous: Yes / ~~No~~

We will treat representations as anonymous where there is a genuine reason to do so; if you wish your name and address details to be withheld then please explain the reason:

fear of intimidation by the business owners

Copies of this representation will be sent to the applicant, or their agent/solicitor, including name and address details (but other personal contact information such as telephone numbers and email addresses will be removed) unless you have specifically requested anonymity. Copies of this representation will be included in a report that will be available to the public and will be published on the internet; however, the published on-line version of the report will have name and address details removed.

Signature: _____ Date: 28 06 23

Please ensure name and address details completed above

Return to:

Licensing Service

Licensing Team, Islington Council, 3rd Floor, 222 Upper St, London, N1 1XR.

Or by email to: licensing@islington.gov.uk

Suggested conditions of approval consistent with the operating schedule

No additional controls have been proposed, current premises licence conditions are as detailed below:

1. The premises shall only operate as a delicatessen and cafe which provides food in the form of substantial meals that are prepared on the premises.
2. Substantial food shall be available throughout the premises and menus shall be displayed.
3. Alcohol for consumption on the premises or at any tables lawfully placed on the highway outside the premises will only be served to customers seated at a table by Waiter or waitress service.
4. The premises licence holder shall ensure that CCTV cameras and recorders are installed at the premises and are of a standard acceptable to and approved by the Police.:
 - a. The system shall be maintained in good working order and at all times the premises is open to the public, be fully operational covering both internal and external areas of the premises to which the public have access;
 - b. One CCTV camera shall be positioned to cover the entrance/exit in order to capture clear, facial images of all persons entering/leaving the premises;
 - c. The CCTV camera views shall not be obstructed;
 - d. The medium on which CCTV images are recorded shall be of evidential quality; stored securely; shall be retained for a period of 31 days; and be available for inspection by the Police or Local Authority upon request;
 - e. At all times when the premises are open for the purposes of licensable activities, subject to the Data Protection Act 2018, a suitably trained member of staff shall be available to assist the Police or an authorised officer in obtaining the CCTV footage;
 - f. Subject to the Data Protection Act 2018, copies shall be made available within 48 hours to the Police or Local Authority, upon request;
 - g. The facility to transfer the images to a compatible, removable format, shall be held on the premises;
 - h. At least one member of working staff at the premises shall be trained in the use of CCTV and a log will be kept to verify this; and
 - i. Signs shall be displayed in the customer areas to advise that CCTV is in operation.
5. Notices shall be displayed within the premises warning customers about personal thefts; and to be vigilant.
6. When the venue is open for licensable activities, the toilet shall be checked by staff at least every two hours and these checks are to be documented on each visit.

7. The licensee shall adopt a 'Challenge 25' policy and promote it through the prominent display of posters. Only suitable forms of photographic identification, such as passport or UK driving licence or a holographically marked PASS scheme cards, will be accepted.
8. The licensee shall ensure that staff are trained about age restricted products and ensure that they sign to confirm that they have understood the training.
9. The licensee shall ensure that staff are trained, as appropriate, in respect of relevant Licensing Law; crime scene best practice and upon the sale of alcohol to drunks. and to persons underage.
10. The licensee shall keep records of training and instructions given to staff, detailing the areas covered, and make them available for inspection upon request by the licensing team, police or trading standards.
11. The licensee shall require staff to note any refusals to sell to young people in a refusals log. The refusals log shall be made available for inspection upon request by the licensing team, police or trading standards.
- ~~12. All sales of alcohol for consumption off the premises shall be in sealed containers except to persons seated at tables lawfully placed on the highway.~~
See below for Noise agreed condition, 38.
13. Staff shall ensure a quiet, safe dispersal of customers, with appropriate signage requesting customers to respect neighbouring residents and businesses.
14. An incident log shall be kept at the premises and made available on request to an authorised officer of the Council or the Police, which will record the following:
 - a. all crimes reported to the venue;
 - b. all ejections of patrons;
 - c. any complaints received;
 - d. any incidents of disorder;
 - e. all seizures of drugs or offensive weapons;
 - f. any refusal of the sale of alcohol see condition 25 on refusals log; and
 - g. any visit by a relevant authority or emergency service.
15. No noise shall emanate from the premises nor vibration be transmitted through the structure of the premises which gives rise to a nuisance.
16. There shall be no promotions that encourage illegal, irresponsible or immoderate consumption of alcohol.
17. Should alcohol deliveries apply, the premises licence holder shall ensure that any third party deliver/courier company is instructed to comply with the following:
 - a. Any refusals will be logged by the delivery driver. Records of all refusals will be obtained from the delivery company and provided to the relevant authorities upon request; and
 - b. Couriers will be trained on relevant aspects of the Licensing Act 2003 including underage sales, sales to a person who is drunk, obtaining alcohol for a child or a person who is drunk and delivering alcohol to someone under the age of 18.

18. In the event that an assault is committed on the premises (or appears to have been committed) the management will immediately ensure that:
 - a. The police (and, where appropriate, the London Ambulance Service) are called without delay;
 - b. The crime scene is preserved so as to enable a full forensic investigation to be carried out by the police; and
 - c. Such other measures are taken (as appropriate) to fully protect the safety of all persons present on the premises.
19. The delivery of licensable goods to the premises shall be restricted to the hours between 07:00 and 23:00 Monday-Saturday. No deliveries to the premises shall be made on a Sunday or Bank Holiday.
20. Alcohol shall not be sold or supplied on the premises otherwise than to persons purchasing food there and for consumption by such a person as an ancillary to their meal.
21. The shutters to the front of the premises shall be maintained so as not to cause a noise nuisance when in operation to residential properties in close vicinity.
22. The outside frontage shall be swept and cleared of any rubbish and smoking litter associated with the business at the end of trade each evening.
23. The outside of the premises shall be regularly monitored to ensure that noise levels from patrons do not cause a nuisance to any nearby residents.
24. Any outdoor furniture shall be fitted with rubber pads to the bottom of the legs to minimise noise when moved.
25. There be no off sale deliveries of alcohol.

Conditions of approval agreed with the Council's Noise Service

26. In the event of a noise/nuisance complaint substantiated by an authorised officer, the licensee shall take appropriate measures in order to prevent any recurrence.
27. Prominent, clear and legible notices must be displayed at all exits requesting the public to respect the needs of local residents and to leave the premises and the area quietly.
28. Any music shall be restricted to ambient background levels of sound.
29. All doors and windows will remain closed from 21:00 hours, except for access or egress.
30. All speakers will be positioned as to face away from doors or windows.
31. All speakers will be mounted away from walls adjacent to residential properties.
32. No more than 5 patrons, at any one time, shall use the frontage of the premises to smoke after 22:00hrs until closing. Signage shall be displayed to advise customers of this.
33. In the event of noise nuisance being established, the licensee shall appoint an acoustic consultant accredited by the Institute of Acoustics or the Association of Noise Consultants to install an entertainment noise control system and come to agreements with the Council regarding maximum levels of amplified sound at the premises.
34. If the above licence condition is required, the agreed maximum levels of amplified sound shall be expressed on the premises licence.

35. If the above licence condition is required, the entertainment noise control system shall be monitored, checked and calibrated as necessary, so that the levels approved by the Council, are not exceeded.
36. The controls for the entertainment noise control system shall be located in a secure, lockable cupboard or similar location. The entertainment noise control system is to be independent of control by persons other than the licensee. Access to the entertainment noise control system is to be restricted to the Licensee or a designated manager.
37. No amplification system or speakers will be used in the external areas of the premises.
38. Drinks shall not be taken outside in open containers for consumption apart from to customers seated in any authorised area for external tables and chairs.
39. The outside seating area shall be closed and cleared of customers by 22.00.
40. Outside furniture shall be disabled and taken out of use by 22.30 each night.



Public Protection/Licensing
222 Upper Street, London
N1 1XR

Report of: Director of Community Safety, Resilience and Community

Meeting of: Licensing Sub-Committee

Date: 01/08/2023

Ward(s): Clerkenwell



Subject:

PREMISES LICENCE NEW APPLICATION

Re: KATSUMAMA, UNIT 4 ROSEBERY CT,
36A ROSEBERY AVENUE, EC1R 5HP

1. Synopsis

1.1. This is an application for a new premise licence under the Licensing Act 2003.

1.2. The new application is to allow:

- The On Sales of Alcohol from 12:00 until 23:00 Monday to Sunday.
- Opening hours of the premises from 12:00 until 23:00 Monday to Sunday.

1.3. Relevant Representations:

Licensing Authority	No
Metropolitan Police	No - Conditions Agreed

Noise	No - Conditions Agreed
Health and Safety	No
Trading Standards	No
Public Health	No
Safeguarding Children	No
London Fire Brigade	No
Local residents	Yes: Three resident representations
Other bodies	No:

2. Recommendations

- 2.1. To determine the application for a new premises licence under Section 17 of the Licensing Act 2003.
- 2.2. This premises is located in the Clerkenwell Cumulative Impact Area therefore the Licensing Sub-Committee will need to consider Licensing Policy 3, which states that there is a presumption of refusal unless the Sub-Committee is satisfied that there will be no adverse cumulative impact on the licensing objectives.
- 2.3. The application form addresses the Cumulative Impact Area and Policy by suggesting a number of conditions in the Operating Schedule. The applicants further endorse these conditions by accepting conditions suggested by the Police and Islington Council's Noise Service.
- 2.4. If the Licensing Sub-Committee grants the application it should be subject to:
 - i. Conditions prepared by the Licensing Officer which are consistent with the Operating Schedule (see appendix 3); and
 - ii. Any conditions deemed appropriate by the Licensing Sub-Committee to promote the four licensing objectives.

3. Background

- 3.1 The application describes the premises as being a restaurant.
- 3.2 This is an application for on sales of alcohol from 12:00 until 23:00 Monday to Sunday.

- 3.3 The application received three letters of representation from local residents.
- 3.4 The applicant has accepted conditions requested with the Police and Islington's Noise Service.

4. Implications

4.1. Financial Implications

- 4.1.1. The Head of Finance reports that the applicant has paid the application fee of £190.00. Should the application be refused, the fee is not refundable.

4.2. Legal Implications

- 4.2.1. The legal implications are set out in Paragraph 2.
- 4.2.2. Legal advice will be provided at the meeting of the Licensing Sub-Committee as necessary.

4.3. Environmental Implications and contribution to achieving a net zero carbon Islington by 2030

- 4.3.1. The Licensing Sub-Committee need to consider the impacts that the proposals will have on the environment. An impact is defined as any change to the environment, whether positive or negative, wholly or partially resulting from Council activities. Almost all human activity has some impact on the environment, and it is very unlikely that any activity will not have any implications.

4.4. Equalities Impact Assessment

- 4.4.1. The council must, in the exercise of its functions, have due regard to the need to eliminate discrimination, harassment and victimisation, and to advance equality of opportunity, and foster good relations, between those who share a relevant protected characteristic and those who do not share it (section 149 Equality Act 2010). The council has a duty to have due regard to the need to remove or minimise disadvantages, take steps to meet needs, in particular steps to take account of disabled persons' disabilities, and encourage people to participate in public life. The council must have due regard to the need to tackle prejudice and promote understanding.
- 4.4.2. An Equalities Impact Assessment is not required in relation to this report, because this is a decision relating to a Premises Licence application under the Licensing Act 2003.

4.5. **Planning implications**

- 4.5.1 The Planning department confirmed the use as a restaurant is lawful and that the premises does not have any restrictive conditions in relation to opening hours. Planning has no concerns with regards proposed licence.

5. **Conclusion and reasons for recommendations**

- 5.1. That the Licensing Sub-Committee determines this application.

Appendices:

Appendix 1: The application form;

Appendix 2: The representation;

Appendix 3: Suggested conditions and map of premises location.

Background papers:

- None.

Final report clearance:

Authorised by:

Terrie Lane

Licensing Manager

Date:

21st July 2023

Report author: Licensing Service

Tel: 020 75027 3031

E-mail: licensing@islington.gov.uk

* required information

Section 1 of 21

You can save the form at any time and resume it later. You do not need to be logged in when you resume.

System reference

Not Currently In Use

This is the unique reference for this application generated by the system.

Your reference

Restaurant

You can put what you want here to help you track applications if you make lots of them. It is passed to the authority.

Are you an agent acting on behalf of the applicant?

Yes No

Put "no" if you are applying on your own behalf or on behalf of a business you own or work for.

Applicant Details

* First name

Phool Prasad

* Family name

Sharma

* E-mail

[REDACTED]

Main telephone number

[REDACTED]

Include country code.

Other telephone number

[REDACTED]

Indicate here if you would prefer not to be contacted by telephone

Are you:

- Applying as a business or organisation, including as a sole trader
 Applying as an individual

A sole trader is a business owned by one person without any special legal structure. Applying as an individual means you are applying so you can be employed, or for some other personal reason, such as following a hobby.

Applicant Business

Is your business registered in the UK with Companies House?

Yes No

Note: completing the Applicant Business section is optional in this form.

Registration number

14065302

Business name

PHOOL PRASAD SHARMA LTD

If your business is registered, use its registered name.

VAT number

- [REDACTED]

Put "none" if you are not registered for VAT.

Legal status

Private Limited Company

Continued from previous page...

Your position in the business

Home country

The country where the headquarters of your business is located.

Registered Address

Address registered with Companies House.

Building number or name

Street

District

City or town

County or administrative area

Postcode

Country

Section 2 of 21

PREMISES DETAILS

I/we, as named in section 1, apply for a premises licence under section 17 of the Licensing Act 2003 for the premises described in section 2 below (the premises) and I/we are making this application to you as the relevant licensing authority in accordance with section 12 of the Licensing Act 2003.

Premises Address

Are you able to provide a postal address, OS map reference or description of the premises?

- Address OS map reference Description

Postal Address Of Premises

Building number or name

Street

District

City or town

County or administrative area

Postcode

Country

Further Details

Telephone number

Non-domestic rateable value of premises (£)

Section 3 of 21

APPLICATION DETAILS

In what capacity are you applying for the premises licence?

- An individual or individuals
- A limited company / limited liability partnership
- A partnership (other than limited liability)
- An unincorporated association
- Other (for example a statutory corporation)
- A recognised club
- A charity
- The proprietor of an educational establishment
- A health service body
- A person who is registered under part 2 of the Care Standards Act 2000 (c14) in respect of an independent hospital in Wales
- A person who is registered under Chapter 2 of Part 1 of the Health and Social Care Act 2008 in respect of the carrying on of a regulated activity (within the meaning of that Part) in an independent hospital in England
- The chief officer of police of a police force in England and Wales

Confirm The Following

- I am carrying on or proposing to carry on a business which involves the use of the premises for licensable activities
- I am making the application pursuant to a statutory function
- I am making the application pursuant to a function discharged by virtue of Her Majesty's prerogative

Section 4 of 21

NON INDIVIDUAL APPLICANTS

Provide name and registered address of applicant in full. Where appropriate give any registered number. In the case of a partnership or other joint venture (other than a body corporate), give the name and address of each party concerned.

Non Individual Applicant's Name

Name

Details

Registered number (where applicable)

Description of applicant (for example partnership, company, unincorporated association etc)

Continued from previous page...

Company

Address

Building number or name

Street

District

City or town

County or administrative area

Postcode

Country

Contact Details

E-mail

Telephone number

Other telephone number

* Date of birth / /

* Nationality [Documents that demonstrate entitlement to work in the UK](#)

Add another applicant

Section 5 of 21

OPERATING SCHEDULE

When do you want the premises licence to start? / /
dd mm yyyy

If you wish the licence to be valid only for a limited period, when do you want it to end / /
dd mm yyyy

Provide a general description of the premises

For example the type of premises, its general situation and layout and any other information which could be relevant to the licensing objectives. Where your application includes off-supplies of alcohol and you intend to provide a place for consumption of these off- supplies you must include a description of where the place will be and its proximity to the premises.

Restaurant and take away

Continued from previous page...

If 5,000 or more people are expected to attend the premises at any one time, state the number expected to attend

Section 6 of 21

PROVISION OF PLAYS

[See guidance on regulated entertainment](#)

Will you be providing plays?

- Yes No

Section 7 of 21

PROVISION OF FILMS

[See guidance on regulated entertainment](#)

Will you be providing films?

- Yes No

Section 8 of 21

PROVISION OF INDOOR SPORTING EVENTS

[See guidance on regulated entertainment](#)

Will you be providing indoor sporting events?

- Yes No

Section 9 of 21

PROVISION OF BOXING OR WRESTLING ENTERTAINMENTS

[See guidance on regulated entertainment](#)

Will you be providing boxing or wrestling entertainments?

- Yes No

Section 10 of 21

PROVISION OF LIVE MUSIC

[See guidance on regulated entertainment](#)

Will you be providing live music?

- Yes No

Section 11 of 21

PROVISION OF RECORDED MUSIC

[See guidance on regulated entertainment](#)

Will you be providing recorded music?

- Yes No

Section 12 of 21

PROVISION OF PERFORMANCES OF DANCE

[See guidance on regulated entertainment](#)

Will you be providing performances of dance?

Continued from previous page...

Section 13 of 21

PROVISION OF ANYTHING OF A SIMILAR DESCRIPTION TO LIVE MUSIC, RECORDED MUSIC OR PERFORMANCES OF DANCE

[See guidance on regulated entertainment](#)

Will you be providing anything similar to live music, recorded music or performances of dance?

- Yes No

Section 14 of 21

LATE NIGHT REFRESHMENT

Will you be providing late night refreshment?

- Yes No

Section 15 of 21

SUPPLY OF ALCOHOL

Will you be selling or supplying alcohol?

- Yes No

Standard Days And Timings

MONDAY

Start

End

Start

End

Give timings in 24 hour clock.
(e.g., 16:00) and only give details for the days
of the week when you intend the premises
to be used for the activity.

TUESDAY

Start

End

Start

End

WEDNESDAY

Start

End

Start

End

THURSDAY

Start

End

Start

End

FRIDAY

Start

End

Start

End

SATURDAY

Start

End

Start

End

Continued from previous page...

SUNDAY

Start

End

Start

End

Will the sale of alcohol be for consumption:

- On the premises Off the premises Both

If the sale of alcohol is for consumption on the premises select on, if the sale of alcohol is for consumption away from the premises select off. If the sale of alcohol is for consumption on the premises and away from the premises select both.

State any seasonal variations

For example (but not exclusively) where the activity will occur on additional days during the summer months.

Non-standard timings. Where the premises will be used for the supply of alcohol at different times from those listed in the column on the left, list below

For example (but not exclusively), where you wish the activity to go on longer on a particular day e.g. Christmas Eve.

State the name and details of the individual whom you wish to specify on the licence as premises supervisor

Name

First name

Family name

Date of birth / /
dd mm yyyy

Continued from previous page...

Enter the contact's address

Building number or name	<input type="text"/>
Street	<input type="text"/>
District	<input type="text"/>
City or town	<input type="text"/>
County or administrative area	<input type="text"/>
Postcode	<input type="text"/>
Country	<input type="text" value="United Kingdom"/>
Personal Licence number (if known)	<input type="text"/>
Issuing licensing authority (if known)	<input type="text"/>

PROPOSED DESIGNATED PREMISES SUPERVISOR CONSENT

How will the consent form of the proposed designated premises supervisor be supplied to the authority?

- Electronically, by the proposed designated premises supervisor
- As an attachment to this application

Reference number for consent form (if known)

If the consent form is already submitted, ask the proposed designated premises supervisor for its 'system reference' or 'your reference'.

Section 16 of 21

ADULT ENTERTAINMENT

Highlight any adult entertainment or services, activities, or other entertainment or matters ancillary to the use of the premises that may give rise to concern in respect of children

Give information about anything intended to occur at the premises or ancillary to the use of the premises which may give rise to concern in respect of children, regardless of whether you intend children to have access to the premises, for example (but not exclusively) nudity or semi-nudity, films for restricted age groups etc gambling machines etc.

Section 17 of 21

HOURS PREMISES ARE OPEN TO THE PUBLIC

Standard Days And Timings

MONDAY

Start

End

Start

End

Give timings in 24 hour clock. (e.g., 16:00) and only give details for the days of the week when you intend the premises to be used for the activity.

Continued from previous page...

TUESDAY

Start End

Start End

WEDNESDAY

Start End

Start End

THURSDAY

Start End

Start End

FRIDAY

Start End

Start End

SATURDAY

Start End

Start End

SUNDAY

Start End

Start End

State any seasonal variations

For example (but not exclusively) where the activity will occur on additional days during the summer months.

Non standard timings. Where you intend to use the premises to be open to the members and guests at different times from those listed in the column on the left, list below

For example (but not exclusively), where you wish the activity to go on longer on a particular day e.g. Christmas Eve.

Section 18 of 21

LICENSING OBJECTIVES

Describe the steps you intend to take to promote the four licensing objectives:

a) General – all four licensing objectives (b,c,d,e)

Continued from previous page...

List here steps you will take to promote all four licensing objectives together.

We run the premises only for the licensable activity only. We would have sufficient and competent manpower at the premises. We take responsibility for serving the alcohol by personal license holder or the designated person only. We would avoid drunkenness in the premises and do not server to the underage person. All the necessary required record would be kept of the training and refresher training.

b) The prevention of crime and disorder

We would have CCTV maintained and operated in the premises. CCTV captures the most useful area and notice would be kept in to let the public know the CCTV is in operation and may be used as an evidence. CCTV record image would kept for 31 days. When necessary we would pass a copy of the CCTV record image to the police in the suitable format to carry and retrieve. If any crime take place, we would keep the incident record with date, time and circumstances.

c) Public safety

We would have appropriate fire extinguisher at the relevant location and function of the extinguisher is monitored on a periodical basis by the professional. Main gate is marked with emergency exit door and would be free of obstruction at all time. There would be fire alarm and fire blanket in the kitchen and smoke detector in the dining area. We would have emergency lighting in case of electricity fails that light turns on automatically.

d) The prevention of public nuisance

We request our customers to leave the premises quietly once they finished in regards to the neighbors. This notice would kept at the visibly in the dining area.

e) The protection of children from harm

We would ask ID with the person we appear to be under the age of 25 years with their acceptable photo ID, such as age card, diving license, passport, connexions card, citizen card or an official card issued by HM forces with the photograph and date of birth of the bearer. A register of any refusal would be maintained on the premises. All the staff would be trained for underage sales prevention.

Section 19 of 21

NOTES ON DEMONSTRATING ENTITLEMENT TO WORK IN THE UK

Continued from previous page...

[Applicable to individual applicants only, including those in a partnership which is not a limited liability partnership] I understand I am not entitled to be issued with a licence if I do not have the entitlement to live and work in the UK (or if I am subject to a condition preventing me from doing work relating to the carrying on of a licensable activity) and that my licence will become invalid if I cease to be entitled to live and work in the UK (please read guidance note 15).

The DPS named in this application form is entitled to work in the UK (and is not subject to conditions preventing him or her from doing work relating to a licensable activity) and I have seen a copy of his or her proof of entitlement to work, if appropriate (please see note 15)

Ticking this box indicates you have read and understood the above declaration

This section should be completed by the applicant, unless you answered "Yes" to the question "Are you an agent acting on behalf of the applicant?"

* Full name

* Capacity

* Date / /
dd mm yyyy

Once you're finished you need to do the following:

1. Save this form to your computer by clicking file/save as...
2. Go back to <https://www.gov.uk/apply-for-a-licence/premises-licence/islington/apply-1> to upload this file and continue with your application.

Don't forget to make sure you have all your supporting documentation to hand.

IT IS AN OFFENCE LIABLE TO SUMMARY CONVICTION TO A FINE OF ANY AMOUNT UNDER SECTION 158 OF THE LICENSING ACT 2003, TO MAKE A FALSE STATEMENT IN OR IN CONNECTION WITH THIS APPLICATION

IT IS AN OFFENCE UNDER SECTION 24B OF THE IMMIGRATION ACT 1971 FOR A PERSON TO WORK WHEN THEY KNOW, OR HAVE REASONABLE CAUSE TO BELIEVE, THAT THEY ARE DISQUALIFIED FROM DOING SO BY REASON OF THEIR IMMIGRATION STATUS. THOSE WHO EMPLOY AN ADULT WITHOUT LEAVE OR WHO IS SUBJECT TO CONDITIONS AS TO EMPLOYMENT WILL BE LIABLE TO A CIVIL PENALTY UNDER SECTION 15 OF THE IMMIGRATION, ASYLUM AND NATIONALITY ACT 2006 AND PURSUANT TO SECTION 21 OF THE SAME ACT, WILL BE COMMITTING AN OFFENCE WHERE THEY DO SO IN THE KNOWLEDGE, OR WITH REASONABLE CAUSE TO BELIEVE, THAT THE EMPLOYEE IS DISQUALIFIED

Appendix 2

Rep 1

From: REDACTED

Sent: 11 July 2023 14:25

To: Licensing <Licensing@islington.gov.uk>

Subject: Premises Licence Application, Katsumama, 4 Rosebery Court, EC1R 5HP

To whom it may concern:

As the owner of REDACTED, I am writing to object to the proposal to grant an alcohol licence to a new restaurant, Katsumama (Ground Floor Unit 4, Rosebery Court) from Monday - Sunday, 12:00 - 23:00.

My objection is on the grounds of the Prevention of Public Nuisance. We already have problems of anti-social behaviour in the area, especially around Bath Court, which have been the subject of complaints to Islington Council by our management company, Hindwoods. We also have had numerous problems with late night customers at Kalbi Restaurant (also occupying a Ground Floor unit) spilling out onto the street, drinking, smoking and on occasion obstructing the entrance to our block. The granting of a drinks licence to another premises in the immediate area would exacerbate these problems without improving the quality of life for residents of Rosebery REDACTED and nearby blocks.

I fully understand that in this area of Clerkenwell a balance has to be struck between the needs of commercial premises and the right of residents to quiet enjoyment of their homes. I am also very aware of the benefits that restaurants of many kinds bring to the district and that this is one of its many attractions. However, in this case, I believe that granting a drinks licence to Katsumama tilts the balance too far towards the commercial interest and would be detrimental to residents of Rosebery Court. It means that below our block we would have two licensed premises, serving alcohol seven days a week from midday until late at night. This is surely a step too far and I hope that you will reconsider this proposal.

Yours faithfully

REDACTED

Rep 2

From: REDACTED

Sent: 07 July 2023 08:56

To: Licensing <Licensing@islington.gov.uk>

Subject: unit4 rosebery court

WK/230018527

hi, I am sending this email to object to the granting of a license for unit four for an alcohol license. There are many restaurants on Roseberry Avenue that already have licenses, and that cause nuisance and inconvenience to residence. There is a restaurant two doors along which has coach parties of people, shouting and screaming in the street all night long had a lot of the residents cannot get any sleep because of this already sorry object to another license been granted, as this would cause further disturbance to residence

REDACTED

REDACTED

Rep 3

From: REDACTED

Sent: 07 July 2023 17:20

To: Licensing <Licensing@islington.gov.uk>

Cc: REDACTED

Subject: Response to Premises Licence Application

RE: KATSUMAMA, GROUND FLOOR UNIT 4, ROSEBERY COURT, 36A ROSEBERY AVENUE, ISLINGTON, LONDON, EC1R 5HP

We write in response to the licence application relating to the above-mentioned premises (“the premises”).

Our names are REDACTED and REDACTED. We live at REDACTED

We urge the licensing committee to reject this application. The immediate surroundings are inherently residential in nature.

- The premises itself is within a residential building - Rosebery Court, with around 30 flats.
- Immediately across the road - and facing the premises - are two residential buildings (Barnstaple and Bideford Mansions) with approximately 25 flats.
- Immediately adjacent to the premises is another residential building (Braunton Mansions) with six flats.

While there is one restaurant in the immediate vicinity (Kalbi, 1-2 Rosebery Avenue) and a convenience store (Retail Express, 3 Rosebery Avenue), these businesses do not generate any noise or anti-social behaviour. Nor is there any significant night time activity. We have lived in this area since 2012. There has been no bar and no night time noise during all of that time.

We oppose the application because:

- There are no other premises in the immediate vicinity where alcohol can be consumed on site. There are many bars on Farringdon Road and Exmouth Market. But none near 36A Rosebery Avenue. Allowing this application would result in a significant change to the area.
- A new bar would likely result in noise and disturbance, which is likely to have a negative impact on approximately 60 residential premises in the immediate surroundings. None of these flats have been exposed to a bar before, and there is no good reason why one should be permitted in this location. There are plenty of other units available in nearby areas that are less residential and already populated by bars.
- We are concerned about an increase in public nuisance as a result of a new bar in an area where there are currently none.
- In particular, the proposed operating hours (12.00-23:00) seven days a week is excessive. This will impact on residents (including children) being able to sleep. Rosebery Avenue is very quiet at night - a new bar will invariably result in more noise at night. We are worried that REDACTED son will be kept up at night due to the noise. His bedroom REDACTED the premises.
- A new bar in an area where there are currently none - which is open until 11pm every night - is likely to result in more crime and disorder.

Kind Regards,

REDACTED

Conditions Consistent with the Operating Schedule

Conditions have been reworded by the Responsible Authorities and are listed below.

Conditions proposed by Islington's Noise Service – Agreed

1. Noise or vibration must not emanate from the premises so as to cause a nuisance to nearby properties.
2. In the event of a noise/nuisance complaint substantiated by an authorised officer, the licensee shall take appropriate measures in order to prevent any recurrence.
3. Prominent, clear and legible notices must be displayed at all exits requesting the public to respect the needs of local residents and to leave the premises and the area quietly.
4. The outside frontage shall be swept and cleared of any rubbish and smoking litter associated with the business towards the end of trade each evening.
5. Any music shall be restricted to ambient background levels of sound.
6. Alcohol may only be consumed on the premises while being seated at a table.
7. The last sale of alcohol for consumption on the premises shall be 30 minutes before the stated closing time.
8. No more than 5 patrons, at any one time, shall use the frontage of the premises to smoke after 21:00hrs until closing. Signage shall be displayed to advise customers of this.
9. All doors and windows will remain closed from 21:00 hours, except for access or egress.
10. The shutters to the front of the premises shall be maintained so as not to cause a noise nuisance when in operation to residential properties in close vicinity.
11. The licensee shall practice best endeavours to ensure that no internal combustion engine vehicles are used for deliveries from the premises.
12. If internal combustion engine vehicles are used for deliveries from the premises, the licensee shall ensure that drivers do not park or loiter in the vicinity of residential premises.
13. Alcohol shall not be sold or supplied, via delivery from the premises, otherwise than to persons purchasing food and is ancillary to their meal.
14. The premises will operate a no idling policy.
15. Delivery drivers will conduct the delivery in a manner that will not cause a noise disturbance to the occupiers of any residential properties surrounding the delivery address.

Conditions proposed by the Metropolitan Police- Agreed

1. CCTV shall be installed, operated and maintained at all times that the premises is open for licensable activities, so as to comply with the following criteria;
 - The licensee will ensure that the system is checked every two weeks to ensure that the system is working properly and that the date and time are correct. A record of these checks, showing the date and time of the person checking, shall be kept and made available to police or authorised council officers on request.
 - The police must be informed if the system will not be operating for longer than one day of business for any reason.
 - One camera will show a close-up of the entrance to the premises, to capture a clear, full length image of anyone entering.
 - The system will provide coverage of any exterior part of the premises accessible to the public.
 - The system shall record in real time and recordings will be date and time stamped.
 - Recordings will be kept for a minimum of 31 days and downloaded footage will be provided free of charge to police or authorised council officers on request, (subject to the Data Protection Act 1998) within 24 hours of any request.
2. Clear, permanent signage will be prominently displayed at the entrance to the premises stating:
 - CCTV in operation.
 - Challenge 25 Proof of Age Scheme in operation.
 - Residential Area: Please be respectful of our neighbours and leave quietly.
3. The premises shall operate the Challenge 25 proof of age scheme, where the only acceptable forms of identification shall be:
 - Photographic driving licence.
 - Valid passport.
 - Military/UK Services Photo ID.
 - PASS Hologram ID.
4. Non-intoxicating beverages shall be available to patrons at all times where alcohol is sold, and tap water shall be provided free of charge upon request.
5. The premises shall only operate as a restaurant whereby:
 - All customers are shown to their table;
 - The supply of alcohol is by waiter or waitress service;
 - Substantial meals, freshly prepared and plated on the premises, shall be served and consumed at the table using non disposable crockery/cutlery;
 - Save for the exception made below; alcohol shall only be supplied to persons seated in the premises and taking substantial table meals there, and provided always that the consumption of alcohol by such persons is ancillary to taking such meals.
 - There shall be no vertical drinking anywhere on the premises at any time save for a maximum of 4 persons permitted to be provided with a drink whilst waiting to be shown to their table.

6. An incident log shall be kept at the premises, and made available on request to officers of the police or local authority. Said log shall be updated as soon as reasonably practicable and in any event within 12 hours of any given incident. All entries will be dated, timed, and signed. Said log shall record the following:
 - Any and all crimes reported to the venue.
 - Any and all ejections of customers.
 - Any and all complaints received concerning crime and disorder.
 - Any and all incidents of disorder.
 - Any and all seizures of drugs or offensive weapons.
 - Any and all faults in the CCTV system.
 - Any and all refusals of the sale of alcohol.
 - Any and all visit by a relevant authority or emergency service.
7. There shall be no sales of:
 - beers or ciders of 6.5% abv or greater
 - spirit miniatures
8. A current and direct number for a dedicated local taxi company shall be made available to customers at all times.
9. No drink promotions shall be operated at any time.
10. In the event that any serious assault is (or appears to have been) committed on the premises, the management will immediately ensure that:
 - The police (and, where appropriate, the London Ambulance Service) are called without delay.
 - All measures that are reasonably practicable are taken to apprehend any suspects pending the arrival of the police.
 - The crime scene is preserved so as to enable a full forensic investigation to be carried out by the police.
 - Such other measures are taken (as appropriate) to fully protect the safety of all persons present on the premises.
11. All staff members engaged in selling alcohol on the premises shall, upon induction and every 12 months thereafter, receive training pertinent to the Licensing Act.
 - All such training shall be fully documented, signed by the employee, and kept at the premises for inspection by Police or other authorised officers.
 - Training shall include, but not be limited to:
 - The premises age verification policy
 - Dealing with refusal of sales
 - Identifying attempts by intoxicated persons to purchase alcohol • Identifying signs of intoxication.
12. The licensee shall train and instruct the management and staff to prevent the admission of, and ensure the immediate and orderly departure of:
 - Any and all persons who appear to be drunk and/or disorderly.

- Any and all persons displaying signs of other substance abuse.

13. The premises licence holder shall ensure that any patrons smoking outside of the premises do so in an orderly manner and are regularly monitored by staff so as to ensure that there is no public nuisance or obstruction on the public highway.
14. A fire safety risk assessment shall be completed as per government guidelines on an annual basis (Regulatory Reform (Fire Safety) Order 2005). Maximum venue capacity will be maintained at a level dictated by said risk assessment, as per legislation.
15. A fully stocked first aid kit shall be maintained at the premises and all staff shall be aware of its location.
16. All emergency exits shall be clearly and prominently signed and shall be maintained unobstructed at all times.

This page is intentionally left blank